

SERIES SPL/RPL LIGHT DUTY PLATE

Capacities to 150 lbs.

Standard Features

- Exceeds I.C.M. Standards
- **Load Bearing** - Two full independent rows of hardened and polished ball bearings

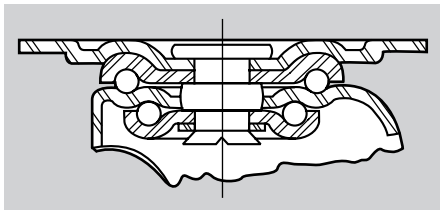

- Case Hardened Raceways
- All Metal Parts Are Stress Relieved
- Finish - Corrosion resistant zinc



SPL-SRP-4

APPLICATIONS:
Light duty stock carts and mobile equipment of all types.



RPL-SRP-4

Optional Features

- Tread Contact Brake - (Suffix -WB)
- Thread Guards - (Suffix -TG)
- Grease Seals - (Suffix -GS)
- NSF Approved



Tread Contact Brake

Wheel Specifications					Caster Specifications					Part Number			
Dia. "A" Inches (mm)	Tread Inches (mm)	Wheel Composition	Ref. to Page	Bearing Type	Axle Dia. Inches (mm)	Load Capacity lbs. (KGS)	Overall Height "B" Inches (mm)	Swivel Radius Inches (mm)	Attach. Bolt Inches (mm)	Approx. Shipping Wt.		Swivel Caster	Rigid Caster
										Swivel lbs. (KGS)	Rigid lbs. (KGS)		
3 (76)	13/16 (21)	Soft Rubber	73	Celcon	1/4 (6)	90 (40.5)	3 3/4 (95)	2 3/4 (70)	5/16 (8)	1.0 (.45)	1.0 (.45)	SPL-SRP-3	RPL-SRP-3
		Hard Rubber	84	Celcon		100 (45.0)				1.0 (.45)	1.0 (.45)	SPL-HRP-3	RPL-HRP-3
		Polyolefin	81	Plain		110 (49.5)				1.0 (.45)	1.0 (.45)	SPL-PBP-3	RPL-PBP-3
		Santoprene (Polyolefin Core)	72	Plain		100 (45.0)				1.0 (.45)	1.0 (.45)	SPL-SPP-3	RPL-SPP-3
		Polyurethane (Polyolefin Core)	80	Plain		100 (45.0)				1.0 (.45)	1.0 (.45)	SPL-PPP-3	RPL-PPP-3
4 (102)	15/16 (24)	Soft Rubber	73	Celcon	5/16 (8)	115 (51.2)	4 13/16 (122.2)	3 5/16 (84)	5/16 (8)	1.4 (.6)	1.2 (.5)	SPL-SRP-4	RPL-SRP-4
		Hard Rubber	84	Celcon		125 (56.2)				1.6 (.7)	1.4 (.6)	SPL-HRP-4	RPL-HRP-4
		Polyolefin	81	Plain		140 (63.0)				1.4 (.6)	1.2 (.5)	SPL-PBP-4	RPL-PBP-4
		Santoprene (Polyolefin Core)	72	Plain		125 (56.2)				1.4 (.6)	1.2 (.5)	SPL-SPP-4	RPL-SPP-4
		Polyurethane (Polyolefin Core)	80	Plain		125 (56.2)				1.4 (.6)	1.2 (.5)	SPL-PPP-4	RPL-PPP-4
5 (127)	15/16 (24)	Soft Rubber	73	Celcon	5/16 (8)	125 (56.2)	5 13/16 (147.5)	3 15/16 (99)	5/16 (8)	2.2 (1.0)	1.8 (.8)	SPL-SRP-5	RPL-SRP-5
		Hard Rubber	84	Celcon		135 (61.0)				2.2 (1.0)	1.8 (.8)	SPL-HRP-5	RPL-HRP-5
		Polyolefin	81	Plain		150 (67.5)				2.0 (.9)	1.6 (.7)	SPL-PBP-5	RPL-PBP-5
		Santoprene (Polyolefin Core)	72	Plain		135 (61.0)				2.0 (.9)	1.6 (.7)	SPL-SPP-5	RPL-SPP-5
		Polyurethane (Polyolefin Core)	80	Plain		135 (61.0)				2.0 (.9)	1.6 (.7)	SPL-PPP-5	RPL-PPP-5

Standard Top Plate

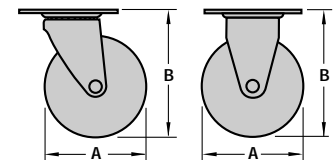
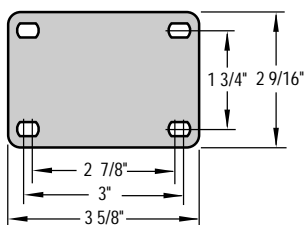

SERIES TL LIGHT DUTY THREADED STEM

Capacities to 135 lbs.

Standard Features

- Exceeds I.C.M. Standards
- **Load Bearing** - Two full independent rows of hardened and polished ball bearings
- **Case Hardened Stamped Steel Construction**
- **All Metal Parts Are Stress Relieved**
- **Finish** - Corrosion resistant zinc

Optional Features

- **Stem Lengths** - Specific stem lengths cut and deburred to order
- **Tread Contact Brake** - (Suffix -WB)
- **Thread Guards** - (Suffix -TG)
- **Grease Seals** - (Suffix -GS)
- **Rigid Casters Available**
- **Special Finishes Available**
- **NSF Approved**

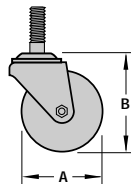

TL-SRP-3-32

TL-SRP-3-32-WB



Tread Contact Brake 3", 4" & 5"



TL-SRP-2-32-WB

Cam Action Brake 2" & 2 1/2"

Stem Selections

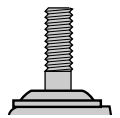

Threaded Stem Size Diameter & Length	Stem Suffix
5/16" - 18" x 1"	-51
5/16" - 18" x 1 1/2"	-52
3/8" - 16" x 1"	-31
3/8" - 16" x 1 1/2"	-32
7/16" - 14" x 1 1/2"	-72
7/16" - 14" x 2 1/8"	-78
1/2" - 13" x 1 1/2"	-12

Add the Stem Suffix to the swivel caster part number.

Example TL-SRP-2-51

Wheel Specifications						Caster Specifications				Part Number	
Dia. "A" Inches (mm)	Tread Inches (mm)	Wheel Composition	Ref. to Page	Bearing Type	Axle Dia. Inches (mm)	Load Capacity lbs. (KGS)	Overall Height "B" Inches (mm)	Swivel Radius Inches (mm)	Approx. Shipping Weight lbs. (KGS)	Caster	Stem Suffix
2 (50)	7/8 (22)	Soft Rubber	73	Celcon	7/32	70 (32)	2 17/32 (64)	1 5/8 (41)	.25 (.11)	TL-SRP-2 . . .	-51, -52, -31, -32
		Hard Rubber	84	Celcon	(5)	90 (41)			.25 (.11)	TL-HRP-2 . . .	
2 1/2 (60)	13/16 (21)	Soft Rubber	73	Celcon	1/4 (6)	80 (36)	3 1/32 (77)	2 1/4 (57)	.36 (.16)	TL-SRP-25 . . .	-51, -52, -31, -32
		Hard Rubber	84	Celcon		90 (41)			.36 (.16)	TL-HRP-25 . . .	
		Polyolefin	81	Celcon		90 (41)			.36 (.16)	TL-PBP-25 . . .	
3 (76)	13/16 (21)	Soft Rubber	73	Celcon	1/4 (6)	90 (41)	3 1/2 (89)	2 3/4 (70)	.63 (.28)	TL-SRP-3 . . .	-51, -52, -31, -32 -72, -78
		Hard Rubber	84	Celcon		100 (45)			.63 (.28)	TL-HRP-3 . . .	
		Santoprene (Polyolefin Core)	72	Plain		100 (45)			.63 (.28)	TL-SPP-3 . . .	
		Polyolefin	81	Plain		100 (45)			.63 (.28)	TL-PBP-3 . . .	
4 (102)	15/16 (24)	Soft Rubber	73	Celcon	5/16 (8)	115 (52)	4 11/16 (119)	3 5/16 (84)	1.3 (.59)	TL-SRP-4 . . .	-32, -72, -78, -12
		Hard Rubber	84	Celcon		125 (56)			1.3 (.59)	TL-HRP-4 . . .	
		Santoprene (Polyolefin Core)	72	Plain		125 (56)			1.3 (.59)	TL-SPP-4 . . .	
		Polyolefin	81	Plain		125 (56)			1.3 (.59)	TL-PBP-4 . . .	
5 (127)	15/16 (24)	Soft Rubber	73	Celcon	5/16 (8)	125 (56)	5 23/32 (145)	3 15/16 (99)	1.7 (.77)	TL-SRP-5 . . .	-32, -72, -78, -12
		Hard Rubber	84	Celcon		135 (61)			1.7 (.77)	TL-HRP-5 . . .	
		Santoprene (Polyolefin Core)	72	Plain		135 (61)			1.7 (.77)	TL-SPP-5 . . .	
		Polyolefin	81	Plain		135 (61)			1.7 (.77)	TL-PBP-5 . . .	

SERIES G2 LIGHT DUTY GRIP RING

Capacities to 300 lbs.

Standard Features

- **Load Bearings** - Independent double ball bearing construction

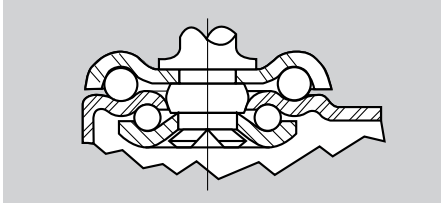

- **Finish** - Corrosion resistant zinc
- **Stem Dimensions** -

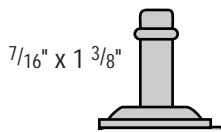

Optional Features

- **Tread Contact Brake** - (Suffix -WB)
Not available in 2" and 2 1/2" sizes
- **Sockets Available for Various Sizes**
(page 68)
- **NSF Approved**

APPLICATIONS:

This series offers a broad selection of wheel materials suitable for the hospital, office, and institutional environment.

Like the G03 series, these casters will adapt to the sockets shown on page 68.



Tread Contact Brake (Suffix -WB)

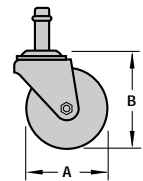

Wheel Specifications						Caster Specifications				Part Number
Dia. "A" Inches (mm)	Tread Inches (mm)	Wheel Composition	Ref. to Page	Bearing Type	Axle Dia. Inches (mm)	Load Capacity lbs. (KGS)	Overall Height "B" Inches (mm)	Swivel Radius Inches (mm)	Approx. Shipping Weight lbs. (KGS)	Caster
2 (50)	7/8 (22)	Soft Rubber	73	Self Lube	1/4 (6)	80 (36)	2 17/32 (64)	2 3/4 (70)	0.5 (.2)	G2-SRP-2
2 1/2 (63)	13/16 (21)	Soft Rubber	73	Self Lube	1/4 (6)	80 (36)	3 1/32 (90)	2 3/4 (70)	0.5 (.2)	G2-SRP-25
		Santoprene (Polyolefin Core)	72	Plain		100 (45)			0.5 (.2)	G2-SPP-25
		Polyurethane (Polyolefin Core)	80	Plain		100 (45)			0.5 (.2)	G2-PPP-25
3 (76)	15/16 (24)	Soft Rubber	73	Celcon	5/16 (8)	90 (40.5)	3 1/2 (89)	2 3/4 (70)	.63 (.28)	G2-SRP-3
		Hard Rubber	84	Celcon		100 (45)			.63 (.28)	G2-HRP-3
		Polyolefin	81	Plain		110 (49.5)			.63 (.28)	G2-PBP-3
		Santoprene (Polyolefin Core)	72	Plain		100 (45)			.63 (.28)	G2-SPP-3
		Polyurethane (Polyolefin Core)	80	Plain		100 (45)			.63 (.28)	G2-PPP-3
4 (102)	15/16 (24)	Soft Rubber	73	Celcon	5/16 (8)	115 (52)	4 11/16 (119)	3 5/16 (84)	1.18 (.53)	G2-SRP-4
		Hard Rubber	74	Celcon		125 (56)			1.18 (.53)	G2-HRP-4
		Polyolefin	81	Plain		140 (63)			1.18 (.53)	G2-PBP-4
		Santoprene (Polyolefin Core)	72	Plain		125 (56)			1.18 (.53)	G2-SPP-4
		Polyurethane (Polyolefin Core)	80	Plain		125 (56)			1.18 (.53)	G2-PPP-4
5 (127)	15/16 (24)	Soft Rubber	73	Celcon	5/16 (8)	125 (56)	5 23/32 (145)	3 15/16 (99)	1.68 (.89)	G2-SRP-5
		Hard Rubber	84	Celcon		135 (61)			1.68 (.89)	G2-HRP-5
		Polyolefin	81	Plain		150 (68)			1.68 (.89)	G2-PBP-5
		Santoprene (Polyolefin Core)	72	Plain		135 (61)			1.68 (.89)	G2-SPP-5
		Polyurethane (Polyolefin Core)	80	Plain		135 (61)			1.68 (.89)	G2-PPP-5

SERIES XL LIGHT DUTY EXPAND. STEM

Capacities to 150 lbs.

XL-SPP-5-150

Expandable
Stem

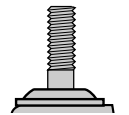
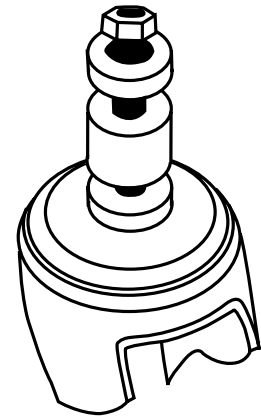

Standard Features

- 3 Piece Socket Expands Into Tubing
- Exceeds I.C.M. Standards
- Load Bearing - Two full independent rows of hardened and polished ball bearings
- Stamped And Formed Construction
- All Metal Parts Are Stress Relieved
- Finish - Corrosion resistant zinc

Optional Features

- Tread Contact Brake - (Suffix -WB)
- Grease Seals - (Suffix -GS)
- Thread Guards - (Suffix -TG)
- NSF Approved

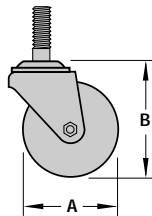

Tread Contact Brake

Stem Selections

Inside Diameter of Tubing	Stem Suffix
3/4" - 1 5/16" Round or Square	-100
1" - 1 3/16" Round or Square	-125
1 1/4" - 1 1/2" Round or Square	-150
1 9/16" - 1 3/4" Round or Square	-175

Add the Stem Code Suffix to the swivel caster part number.

Example XL-SRP-3-100

Wheel Specifications					Caster Specifications				Part Number		
Dia. "A" Inches (mm)	Tread Inches (mm)	Wheel Composition	Ref. to Page	Bearing Type	Axle Dia. Inches (mm)	Load Capacity lbs. (KGS)	Overall Height "B" Inches (mm)	Swivel Radius Inches (mm)	Approx. Shipping Weight lbs. (KGS)	Caster	Stem Code Suffix
3 (76)	1 3/16 (21)	Soft Rubber	73	Celcon	1/4 (6)	90 (40.5)	3 1/2 (89)	2 3/4 (70)	.63 (.28)	XL-SRP-3 ...	-100, -125, -150, -175
		Hard Rubber	84	Celcon		100 (45)			.63 (.28)	XL-HRP-3 ...	
		Polyolefin	81	Plain		110 (49.5)			.63 (.28)	XL-PBP-3	
		Santoprene (Polyolefin Core)	72	Plain		100 (45)			.63 (.28)	XL-SPP-3 ...	
		Polyurethane (Polyolefin Core)	80	Plain		100 (45)			.63 (.28)	XL-PPP-3 ...	
4 (102)	1 5/16 (24)	Soft Rubber	73	Celcon	5/16 (8)	115 (52)	4 11/16 (119)	3 5/16 (84)	1.18 (.53)	XL-SRP-4 ...	-100, -125, -150, -175
		Hard Rubber	84	Celcon		125 (56)			1.18 (.53)	XL-HRP-4 ...	
		Polyolefin	81	Plain		140 (63)			1.18 (.53)	XL-PBP-4	
		Santoprene (Polyolefin Core)	72	Plain		125 (56)			1.18 (.53)	XL-SPP-4 ...	
		Polyurethane (Polyolefin Core)	80	Plain		125 (56)			1.18 (.53)	XL-PPP-4 ...	
5 (127)	1 5/16 (24)	Soft Rubber	73	Celcon	5/16 (8)	125 (56)	5 23/32 (145)	3 15/16 (99)	1.68 (.89)	XL-SRP-5 ...	-100, -125, -150, -175
		Hard Rubber	84	Celcon		135 (61)			1.68 (.89)	XL-HRP-5 ...	
		Polyolefin	81	Plain		150 (68)			1.68 (.89)	XL-PBP-5	
		Santoprene (Polyolefin Core)	72	Plain		135 (61)			1.68 (.89)	XL-SPP-5 ...	
		Polyurethane (Polyolefin Core)	80	Plain		135 (61)			1.68 (.89)	XL-PPP-5 ...	

SERIES 03/04 LIGHT MEDIUM DUTY PLATE

Capacities to 300 lbs.

Standard Features

- **Swivel Casters** - Heavy gauge steel top plate is attached to a full drawn steel horn with integral, hardened raceways

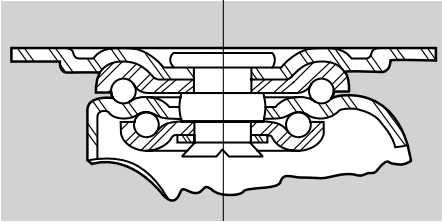

- **Load Bearings** - Two full, independent rows of hardened, polished ball bearings roll freely in large diameter, lubricated raceways
- **King Pin** - Shanked, hardened king pin holds raceways precisely in alignment
- **Wheel Bearings** - Self lubricating, plain, ball, and roller bearings are available
- **Finish** - Corrosion resistant zinc

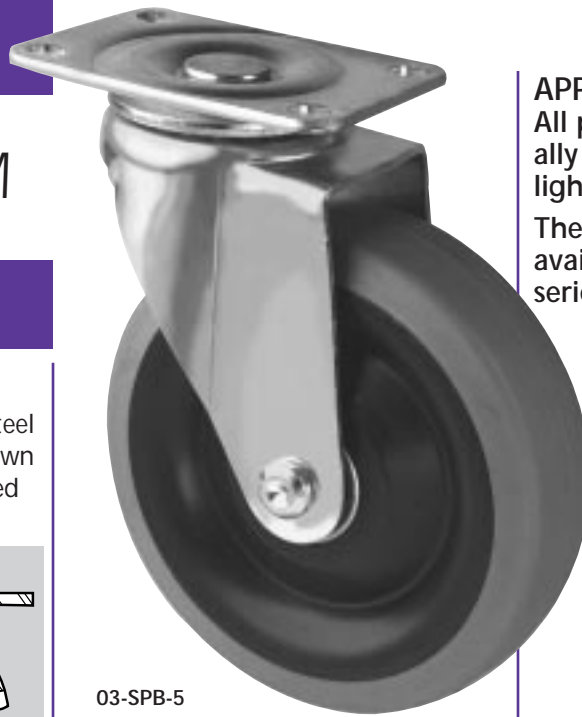

03-SPB-5



APPLICATIONS:

All purpose series found in virtually all institutional as well as light industrial environments.

The range of wheel materials available make this a popular series with schools and hospitals.

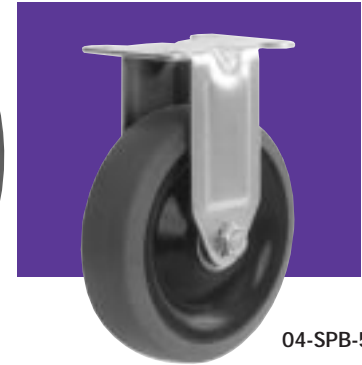

04-SPB-5

Standard Top Plates

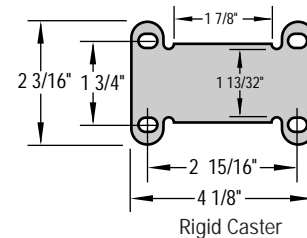
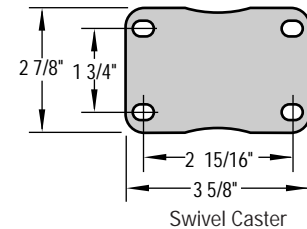

Optional Features

- **Tread Contact Brake** - (Suffix-WB)
Not available on 3" caster, rigid caster, or roller bearing wheels.
- **Grease Seals** - (Suffix -GS)
- **Top Locking Wheel Brake** - (Suffix-TLB)
Available for 3 1/2", 4" and 5" diameters. See page 104.

Wheel Specifications					Caster Specifications						Part Number		
Dia. "A" Inches (mm)	Tread Inches (mm)	Wheel Composition	Ref. to Page	Bearing Type	Axle Dia. Inches (mm)	Load Capacity lbs. (KGS)	Overall Height "B" Inches (mm)	Swivel Radius Inches (mm)	Attach. Bolt Inches (mm)	Approx. Shipping Wt.		Swivel Caster	Rigid Caster
										Swivel lbs. (KGS)	Rigid lbs. (KGS)		
2 1/2 (60)	1 1/8 (29)	Sintered Iron	86	Plain	5/16 (8)	200 (90)	3 5/16 (84)	2 3/8 (60)	5/16 (8)	1.8 (.81)	1.1 (.50)	03-SIP-25	04-SIP-25
		Soft Rubber	73	Self Lube		100 (45)				1.2 (.54)	.90 (.40)	03-SRP-25	04-SRP-25
		Hard Rubber	84	Self Lube		200 (90)				1.2 (.54)	.90 (.40)	03-HRP-25	04-HRP-25
		Polyurethane (Polyolefin Core)	80	Ball		200 (90)				1.3 (.59)	1.0 (.45)	03-PPB-25	04-PPB-25
		Polyolefin (Blk)	81	Plain		200 (90)				1.1 (.50)	.80 (.36)	03-PBP-25	04-PBP-25
		Polyolefin (Wt)	81	Plain		200 (90)				1.1 (.50)	.80 (.36)	03-PWP-25	04-PWP-25
3 (76)	1 5/16 (33)	Sintered Iron	86	Plain	3/8 (10)	300 (135)	3 13/16 (97)	2 3/4 (70)	5/16 (8)	2.0 (.90)	1.8 (.81)	03-SIP-3	04-SIP-3
		Cast Iron	86	Roller		300 (135)				2.4 (1.08)	2.2 (1.0)	03-SSR-3	04-SSR-3
		Soft Rubber	73	Self Lube		175 (79)				1.4 (.63)	1.2 (.54)	03-SRP-3	04-SRP-3
		Soft Rubber	73	Roller		175 (79)				1.4 (.63)	1.2 (.54)	03-SRR-3	04-SRR-3
		Hard Rubber	84	Self Lube		270 (121)				1.4 (.63)	1.2 (.54)	03-HRP-3	04-HRP-3
		Hard Rubber	84	Roller		270 (121)				1.4 (.63)	1.2 (.54)	03-HRR-3	04-HRR-3
	1 3/8 (35)	Polyurethane (Polyolefin Core)	80	Ball	250 (121)	1.5 (.68)	1.3 (.59)	03-PPB-3	04-PPB-3				
		1 1/4 (32)	Solid Urethane	77	Plain	290 (121)	1.5 (.68)	1.3 (.59)	03-KTP-3	04-KTP-3			
			Polyolefin (Blk)	81	Plain	270 (121)	1.1 (.50)	.90 (.40)	03-PBP-3	04-PBP-3			
	Polyolefin (Wt)		81	Plain	270 (121)	1.1 (.50)	.90 (.40)	03-PWP-3	04-PWP-3				
	Phenolic		82	Plain	300 (135)	1.5 (.68)	1.3 (.59)	03-PHP-3	04-PHP-3				
	Phenolic	82	Roller	300 (135)	1.5 (.68)	1.3 (.59)	03-PHR-3	04-PHR-3					

Wheel Specifications						Caster Specifications						Part Number	
Dia. "A" Inches (mm)	Tread Inches (mm)	Wheel Composition	Ref. to Page	Bearing Type	Axle Dia. Inches (mm)	Load Capacity lbs. (KGS)	Overall Height "B" Inches (mm)	Swivel Radius Inches (mm)	Attach. Bolt Inches (mm)	Approx. Shipping Wt.		Swivel Caster	Rigid Caster
										Swivel lbs. (KGS)	Rigid lbs. (KGS)		
3 1/2 (89)	1 1/4 (32)	Cast Iron	86	Plain	3/8 (10)	300 (135)	4 3/4 (121)	3 3/16 (81)	5/16 (8)	3.0 (1.35)	2.6 (1.17)	03-SSP-35	04-SSP-35
		Cast Iron	86	Roller		300 (135)				3.0 (1.35)	2.6 (1.17)	03-SSR-35	04-SSR-35
	1 5/16 (33)	Soft Rubber	73	Self Lube		200 (90)				1.9 (.86)	1.5 (.68)	03-SRP-35	04-SRP-35
		Rubber Tire (Steel Disc)	N/A	Ball		200 (90)				2.2 (1.0)	1.8 (.81)	03-RTB-35	04-RTB-35
	1 1/8 (29)	Hard Rubber	84	Self Lube		275 (124)				1.9 (.86)	1.5 (.68)	03-HRP-35	04-HRP-35
		Hard Rubber	84	Roller		275 (124)				1.9 (.86)	1.5 (.68)	03-HRR-35	04-HRR-35
	1 5/16 (33)	Polyurethane (Polyolefin Core)	80	Ball		250 (112)				1.8 (.81)	1.4 (.63)	03-PPB-35	04-PPB-35
		Polyurethane (Polyolefin Core)	72	Delrin		250 (112)				1.8 (.81)	1.4 (.63)	03-PPD-35	04-PPD-35
		Santoprene (Polyolefin Core)	72	Ball		200 (90)				1.8 (.81)	1.4 (.63)	03-SPB-35	04-SPB-35
		Santoprene (Polyolefin Core)	81	Delrin		200 (90)				1.8 (.81)	1.4 (.63)	03-SPD-35	04-SPD-35
	1 1/4 (32)	Polyolefin (Blk)	81	Plain		270 (121)				1.6 (.72)	1.2 (.54)	03-PBP-35	04-PBP-35
		Polyolefin (Wt)	81	Plain		270 (121)				1.6 (.72)	1.2 (.54)	03-PWP-35	04-PWP-35
		Phenolic	82	Plain		300 (135)				2.0 (.90)	1.6 (.72)	03-PHP-35	04-PHP-35
		Phenolic	82	Roller		300 (135)				2.0 (.90)	1.6 (.72)	03-PHR-35	04-PHR-35
4 (102)	1 1/4 (32)	Cast Iron	86	Plain	3/8 (10)	300 (135)	5 (127)	3 7/16 (87)	5/16 (8)	3.3 (1.49)	2.9 (1.31)	03-SSP-4	04-SSP-4
		Cast Iron	86	Roller		300 (135)				3.3 (1.49)	2.9 (1.31)	03-SSR-4	04-SSR-4
	1 1/8 (29)	Soft Rubber	73	Self Lube		200 (90)				2.2 (1.0)	1.8 (.81)	03-SRP-4	04-SRP-4
		Rubber Tire (Steel Disc)	N/A	Ball		200 (90)				2.5 (1.13)	2.1 (.95)	03-RTB-4	04-RTB-4
	1 1/4 (32)	Hard Rubber	84	Self Lube		275 (124)				2.2 (1.0)	1.8 (.81)	03-HRP-4	04-HRP-4
		Hard Rubber	84	Roller		275 (124)				2.2 (1.0)	1.8 (.81)	03-HRR-4	04-HRR-4
		Solid Urethane	77	Plain		275 (124)				2.2 (1.0)	1.8 (.81)	03-KTP-4	04-KTP-4
	1 3/8 (35)	Polyurethane (Polyolefin Core)	80	Ball		250 (112)				2.1 (.95)	1.7 (.77)	03-PPB-4	04-PPB-4
		Polyurethane (Polyolefin Core)	80	Delrin		250 (112)				2.1 (.95)	1.7 (.77)	03-PPD-4	04-PPD-4
		Santoprene (Polyolefin Core)	72	Ball		200 (90)				2.1 (.95)	1.7 (.77)	03-SPB-4	04-SPB-4
		Santoprene (Polyolefin Core)	72	Delrin		200 (90)				2.1 (.95)	1.7 (.77)	03-SPD-4	04-SPD-4
	1 1/4 (32)	Polyolefin (Blk)	81	Plain		275 (124)				1.9 (.86)	1.5 (.68)	03-PBP-4	04-PBP-4
		Polyolefin (Wt)	81	Plain		275 (124)				1.9 (.86)	1.5 (.68)	03-PWP-4	04-PWP-4
		Phenolic	82	Plain		300 (127)				2.2 (1.0)	1.8 (.81)	03-PHP-4	04-PHP-4
Phenolic		82	Roller	300 (127)	2.2 (1.0)	1.8 (.81)	03-PHR-4	04-PHR-4					
5 (127)	1 1/4 (32)	Cast Iron	86	Plain	3/8 (10)	300 (135)	6 1/8 (156)	3 15/16 (100)	5/16 (8)	3.8 (1.7)	3.4 (1.5)	03-SSP-5	04-SSP-5
		Cast Iron	86	Roller		300 (135)				3.8 (1.7)	3.4 (1.5)	03-SSR-5	04-SSR-5
	1 1/8 (29)	Soft Rubber	72	Self Lube		200 (90)				2.9 (1.3)	2.5 (1.1)	03-SRP-5	04-SRP-5
		Soft Rubber	72	Ball		200 (90)				2.9 (1.3)	2.5 (1.1)	03-SRB-5	04-SRB-5
	1 1/4 (32)	Rubber Tire (Steel Disc)	N/A	Ball		240 (108)				3.0 (1.35)	2.6 (1.2)	03-RTB-5	04-RTB-5
		Hard Rubber	84	Self Lube		275 (124)				2.9 (1.3)	2.5 (1.1)	03-HRP-5	04-HRP-5
		Hard Rubber	84	Roller		275 (124)				2.9 (1.3)	2.5 (1.1)	03-HRR-5	04-HRR-5
	1 3/8 (35)	Solid Urethane	77	Plain		300 (135)				2.9 (1.3)	2.5 (1.1)	03-KTP-5	04-KTP-5
		Polyurethane (Polyolefin Core)	80	Ball		275 (124)				2.9 (1.3)	2.5 (1.1)	03-PPB-5	04-PPB-5
		Polyurethane (Polyolefin Core)	80	Delrin		275 (124)				2.9 (1.3)	2.5 (1.1)	03-PPD-5	04-PPD-5
		Santoprene (Polyolefin Core)	72	Ball		225 (101)				2.9 (1.3)	2.5 (1.1)	03-SPB-5	04-SPB-5
	1 1/4 (32)	Santoprene (Polyolefin Core)	72	Delrin		225 (101)				2.9 (1.3)	2.5 (1.1)	03-SPD-5	04-SPD-5
		Polyolefin (Blk)	81	Plain		275 (124)				2.5 (1.1)	2.1 (.95)	03-PBP-5	04-PBP-5
		Polyolefin (Wt)	81	Plain		275 (124)				2.5 (1.1)	2.1 (.95)	03-PWP-5	04-PWP-5
Phenolic		82	Plain	300 (135)	2.9 (1.3)	2.5 (1.1)	03-PHP-5	04-PHP-5					
1 1/4 (32)	Phenolic	82	Roller	300 (135)	2.9 (1.3)	2.5 (1.1)	03-PHR-5	04-PHR-5					

Optional Top Plates

Add prefix A or D to caster number.
Example: A03-SRP-35

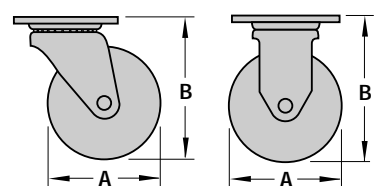
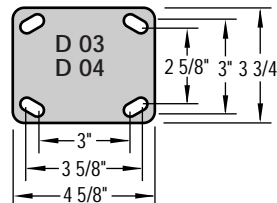
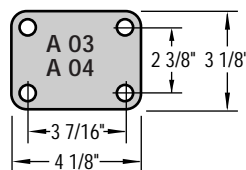

SERIES TM LIGHT MED DUTY THREADED STEM

Capacities to 290 lbs.

Standard Features

- Exceeds I.C.M. Standards
- Load Bearing - Two full independent rows of hardened and polished ball bearings
- Stamped And Formed Construction
- All Metal Parts Are Stress Relieved
- Finish - Corrosion resistant zinc

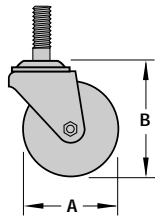

TM-SRP-5-12

Optional Features

- Tread Contact Brake - (Suffix -WB)
- Stem Lengths - Specific stem lengths cut and deburred to order
- Thread Guards - (Suffix -TG)
- Grease Seals - (Suffix -GS)
- Rigid Casters Available
- NSF Approved



Tread Contact Brake

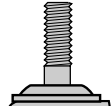

Stem Selections

Threaded Stem Size Diameter & Length	Stem Suffix
7/16" - 14" x 1 1/2"	-72
7/16" - 14" x 2 1/8"	-78
1/2" - 13" x 1 1/2"	-12

Add the Stem Suffix to the swivel caster part number.

Example TM-SRP-3-12

Wheel Specifications					Caster Specifications				Part Number		
Dia. "A" Inches (mm)	Tread Inches (mm)	Wheel Composition	Ref. to Page	Bearing Type	Axle Dia. Inches (mm)	Load Capacity lbs. (KGS)	Overall Height "B" Inches (mm)	Swivel Radius Inches (mm)	Approx. Shipping Weight lbs. (KGS)	Caster	Stem Suffix
3 (76)	1 1/4 (32)	Soft Rubber	73	Self Lube	3/8 (10)	175 (79)	3 13/16 (97)	2 3/4 (70)	1.3 (.59)	TM-SRP-3...	-72, -12
		Hard Rubber	84	Self Lube		270 (130)			1.3 (.59)	TM-HRP-3...	
		Solid Urethane	77	Plain		270 (130)			1.3 (.59)	TM-KTP-3...	
		Santoprene	72	Ball		200 (90)			1.3 (.59)	TM-SPB-3...	
		Polyolefin (Blk)	81	Plain		270 (130)			1.3 (.59)	TM-PBP-3...	
		Polyolefin (Wt)	81	Plain		270 (130)			1.3 (.59)	TM-PWP-3...	
3 1/2 (89)	1 1/4 (32)	Soft Rubber	73	Self Lube	3/8 (10)	200 (124)	4 3/4 (121)	3 3/16 (81)	1.9 (.86)	TM-SRP-35...	-72, -78, -12
		Hard Rubber	84	Self Lube		275 (90)			1.9 (.86)	TM-HRP-35...	
	1 3/8 (35)	Santoprene (Polyolefin Core)	72	Ball		200 (90)			2.2 (1.0)	TM-SPB-35...	
		Polyurethane (Polyolefin Core)	80	Ball		275 (124)			2.2 (1.0)	TM-SPD-35...	
		Polyurethane (Polyolefin Core)	80	Delrin		275 (124)			2.2 (1.0)	TM-PPB-35...	
		Polyurethane (Polyolefin Core)	80	Delrin		275 (124)			2.2 (1.0)	TM-PPD-35...	
4 (102)	1 1/4 (32)	Soft Rubber	73	Self Lube	3/8 (10)	200 (90)	5 (127)	3 7/16 (87)	2.2 (1.0)	TM-SRP-4...	-72, -78, -12
		Hard Rubber	84	Self Lube		275 (124)			2.2 (1.0)	TM-HRP-4...	
		Solid Urethane	77	Plain		275 (124)			2.2 (1.0)	TM-KTP-4...	
	1 3/8 (35)	Santoprene (Polyolefin Core)	72	Ball		200 (90)			2.1 (.95)	TM-SPB-4...	
		Santoprene (Polyolefin Core)	72	Delrin		200 (90)			2.1 (.95)	TM-SPD-4...	
		Polyurethane (Polyolefin Core)	80	Ball		250 (113)			2.1 (.95)	TM-PPB-4...	
		Polyurethane (Polyolefin Core)	80	Delrin		250 (113)			2.1 (.95)	TM-PPD-4...	
		Polyolefin (Blk)	81	Plain		275 (124)			1.9 (.86)	TM-PBP-4...	
		Polyolefin (Blk)	81	Plain		275 (124)			1.9 (.86)	TM-PWP-4...	
		Polyolefin (Wt)	81	Plain		275 (124)			1.9 (.86)	TM-PWP-4...	
5 (127)	1 1/4 (32)	Soft Rubber	73	Self Lube	3/8 (10)	240 (104)	6 (152)	3 15/16 (99)	2.9 (1.3)	TM-SRP-5...	-72, -78, -12
		Hard Rubber	84	Self Lube		290 (131)			2.9 (1.3)	TM-HRP-5...	
		Solid Urethane	77	Plain		290 (131)			2.9 (1.3)	TM-KTP-5...	
	1 3/8 (35)	Santoprene (Polyolefin Core)	72	Ball		225 (101)			2.9 (1.3)	TM-SPB-5...	
		Santoprene (Polyolefin Core)	72	Delrin		225 (101)			2.9 (1.3)	TM-SPD-5...	
		Polyurethane (Polyolefin Core)	80	Ball		275 (124)			2.9 (1.3)	TM-PPB-5...	
		Polyurethane (Polyolefin Core)	80	Delrin		275 (124)			2.9 (1.3)	TM-PPD-5...	
		Polyolefin (Blk)	81	Plain		290 (131)			2.5 (1.13)	TM-PBP-5...	
		Polyolefin (Blk)	81	Plain		290 (131)			2.5 (1.13)	TM-PWP-5...	
		Polyolefin (Wt)	81	Plain		290 (131)			2.5 (1.13)	TM-PWP-5...	
6 (152)	1 3/8 (35)	Santoprene (Polyolefin Core)	72	Ball	3/8 (10)	225 (101)	7 9/16 (192)	4 3/4 (121)	2.9 (1.3)	TM-SPB-6...	-72, -78, -12
		Santoprene (Polyolefin Core)	72	Delrin		225 (101)			2.9 (1.3)	TM-SPD-6...	
		Polyurethane (Polyolefin Core)	80	Ball		275 (124)			2.9 (1.3)	TM-PPB-6...	
		Polyurethane (Polyolefin Core)	80	Delrin		275 (124)			2.9 (1.3)	TM-PPD-6...	

SERIES G03 LIGHT MED DUTY GRIP RING

Capacities to 275 lbs.

Standard Features

- Exceeds ICM Standards
- Load Bearings - Two full independent rows of hardened and polished ball bearings

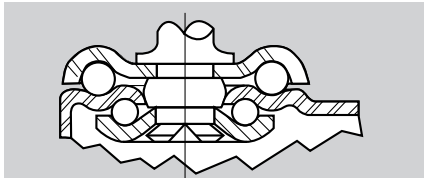

- Finish - Corrosion resistant zinc
- Stem Dimensions - $7/16" \times 1 \ 3/8"$

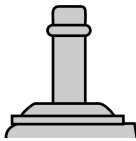

Optional Features

- Tread Contact Brake - (Suffix -WB)
- NSF Approved

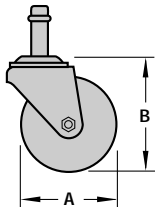

G03-SRP-5



APPLICATIONS:

This versatile caster is used in a variety of institutional, food service, and office equipment.

Stem and socket combinations for all standard tubing sizes. Additional sockets and brackets are shown on page 68.

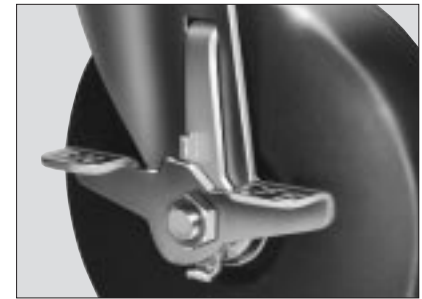

Tread Contact Brake (Suffix -WB)

SOCKETS FOR STEM CASTERS

New Patented Reinforced Thermoplastic Design - Unlike plastic or steel, sockets will not loosen or wear.

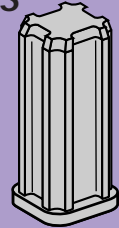

Sockets for Square Tubing

Sockets for Round Tubing

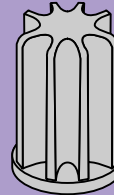

Socket #	Fits Round I.D. Tube
RD1	.777
RD2	.872
RD3	.894
RD9	.902
RD4	1.072
RD5	1.12
RD6	1.31
RD7	1.495

Socket #	Fits Square I.D. Tube
SQ1	.620
SQ2	.650
SQ3	.870
SQ4	.902
SQ5	1.101
SQ6	1.120
SQ7	1.140
SQ8	1.150
SQ9	1.152
SQ10	1.40

Wheel Specifications						Caster Specifications				Part Number
Dia. "A" Inches (mm)	Tread Inches (mm)	Wheel Composition	Ref. to Page	Bearing Type	Axle Dia. Inches (mm)	Load Capacity lbs. (KGS)	Height "B" Inches (mm)	Swivel Radius Inches (mm)	Approx. Shipping Weight lbs. (KGS)	Caster
3 (76)	1 1/4 (32)	Polyolefin	81	Plain	3/8 (10)	270 (121)	3 13/16 (97)	2 3/4 (70)	1.1 (.50)	G03-PBP-3
		Soft Rubber	73	Self Lube		175 (79)			1.4 (.63)	G03-SRP-3
		Solid-Urethane	77	Plain		290 (131)			1.5 (.68)	G03-KTP-3
	1 3/8 (35)	Santoprene (Polyolefin Core)	72	Ball		200 (90)			1.5 (.68)	G03-SPB-3
		Delrin	72	Delrin		200 (90)			1.5 (.68)	G03-SPD-3
		Polyurethane (Polyolefin Core)	80	Ball		250 (112)			1.5 (.68)	G03-PPB-3
		Delrin	80	Delrin		250 (112)			1.5 (.68)	G03-PPD-3
		4 (102)	1 1/4 (32)	Polyolefin		81			Plain	275 (124)
Soft Rubber	73			Self Lube	200 (90)	2.2 (1.0)	G03-SRP-4			
Solid-Urethane	77			Plain	290 (131)	2.2 (1.0)	G03-KTP-4			
1 3/8 (35)	Santoprene (Polyolefin Core)		72	Ball	200 (90)	2.1 (.95)	G03-SPB-4			
	Delrin		72	Delrin	200 (90)	2.1 (.95)	G03-SPD-4			
	Polyurethane (Polyolefin Core)		80	Ball	250 (112)	2.1 (.95)	G03-PPB-4			
	Delrin		80	Delrin	250 (112)	2.1 (.95)	G03-PPD-4			
	5 (127)		1 1/4 (32)	Polyolefin	81	Plain	275 (124)	3/8 (10)	6 1/8 (156)	3 15/16 (100)
Soft Rubber		73		Self Lube	200 (90)	2.9 (1.3)	G03-SRP-5			
Solid-Urethane		77		Plain	300 (135)	2.9 (1.3)	G03-KTP-5			
1 3/8 (35)		Santoprene (Polyolefin Core)	72	Ball	225 (101)	2.9 (1.3)	G03-SPB-5			
		Delrin	72	Delrin	225 (101)	2.9 (1.3)	G03-SPD-5			
		Polyurethane (Polyolefin Core)	80	Ball	275 (124)	2.9 (1.3)	G03-PPB-5			
		Delrin	80	Delrin	275 (124)	2.9 (1.3)	G03-PPD-5			

SERIES XM LIGHT MED DUTY EXPAND. STEM

Capacities to 300 lbs.

XM-PPB-5-125



Expandable
Stem

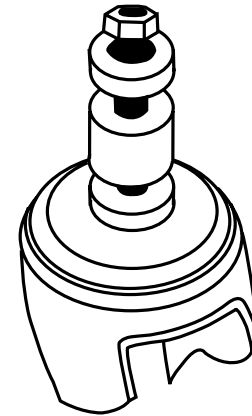

Standard Features

- 3 Piece Polypropylene Socket Expands Into Tubing
- Exceeds I.C.M. Standards
- Load Bearing - Two full independent rows of hardened and polished ball bearings
- Stamped And Formed Construction
- All Metal Parts Are Stress Relieved
- Finish - Corrosion resistant zinc

Optional Features

- Tread Contact Brake - (Suffix -WB)
- Grease Seals - (Suffix -GS)
- Thread Guards - (Suffix -TG)
- Available In Stainless Steel
- NSF Approved

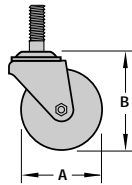

Tread Contact Brake

Stem Selections

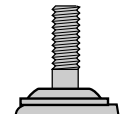

Inside Diameter of Tubing	Stem Suffix
3/4" - 15/16" Round or Square	-100
1" - 1 3/16" Round or Square	-125
1 1/4" - 1 1/2" Round or Square	-150
1 9/16" - 1 3/4" Round or Square	-175

Add the Stem Code Suffix to the swivel caster part number.

Example XM-SRP-35-100

Wheel Specifications					Caster Specifications					Part Number	
Dia. "A" Inches (mm)	Tread Inches (mm)	Wheel Composition	Ref. to Page	Bearing Type	Axle Dia. Inches (mm)	Load Capacity lbs. (KGS)	Overall Height "B" Inches (mm)	Swivel Radius Inches (mm)	Approx. Shipping Weight lbs. (KGS)	Caster	Stem Suffix
3 1/2 (89)	1 5/16 (33)	Soft Rubber	73	Self Lube	3/8 (10)	200 (90)	4 3/4 (121)	3 3/16 (81)	1.9 (.86)	XM-SRP-35 . . .	-100, -125, -150, -175
	1 1/8 (29)	Rubber Tire (Steel Disc)	N/A	Ball		200 (90)			2.2 (1.0)	XM-RTB-35 . . .	
	1 3/8 (35)	Santoprene (Polyolefin Core)	72	Ball		200 (90)			1.6 (.72)	XM-SPB-35 . . .	
			72	Delrin		200 (90)			1.6 (.72)	XM-SPD-35 . . .	
		Polyurethane (Polyolefin Core)	80	Ball		225 (101)			1.6 (.72)	XM-PPB-35 . . .	
			80	Delrin		225 (101)			1.6 (.72)	XM-PPD-35 . . .	
4 (102)	1 1/4 (32)	Soft Rubber	73	Self Lube	3/8 (10)	200 (90)	5 (127)	3 7/8 (87)	2.2 (1.0)	XM-SRP-4 . . .	-100, -125, -150, -175
	1 1/8 (29)	Rubber Tire (Steel Disc)	N/A	Ball		200 (90)			2.4 (1.0)	XM-RTB-4 . . .	
	1 1/4 (32)	Solid Urethane	77	Plain		275 (124)			1.9 (.86)	XM-KTP-4 . . .	
		Santoprene (Polyolefin Core)	72	Ball		200 (90)			2.7 (1.2)	XM-SPB-4 . . .	
			72	Delrin		200 (90)			2.7 (1.2)	XM-SPD-4 . . .	
		Polyurethane (Polyolefin Core)	80	Ball		250 (112)			2.7 (1.2)	XM-PPB-4 . . .	
			80	Delrin		250 (112)			2.7 (1.2)	XM-PPD-4 . . .	
		5 (127)	1 1/4 (32)	Soft Rubber		73			Self Lube	3/8 (10)	
1 1/8 (29)	Rubber Tire (Steel Disc)		N/A	Ball	240 (108)	3.0 (1.4)	XM-RTB-5 . . .				
1 1/4 (32)	Solid Urethane		77	Plain	300 (135)	3.1 (1.4)	XM-KTP-5 . . .				
	Santoprene (Polyolefin Core)		72	Ball	225 (101)	3.6 (1.6)	XM-SPB-5 . . .				
			72	Delrin	225 (101)	3.6 (1.6)	XM-SPD-5 . . .				
	Polyurethane (Polyolefin Core)		80	Ball	275 (124)	3.6 (1.6)	XM-PPB-5 . . .				
80		Delrin	275 (124)	3.6 (1.6)	XM-PPD-5 . . .						
6 (152)	1 3/8 (35)	Santoprene (Polyolefin Core)	72	Ball	3/8 (10)	250 (112)	7 9/16 (192)	4 7/8 (124)	4.0 (1.8)	XM-SPB-6 . . .	-100, -125, -150, -175
		Polyurethane (Polyolefin Core)	72	Delrin		250 (112)			4.0 (1.8)	XM-SPD-6 . . .	
			80	Ball		250 (112)			4.0 (1.8)	XM-PPB-6 . . .	
		80		Delrin		250 (112)			4.0 (1.6)	XM-PPD-6 . . .	

SERIES CL LIGHT MED DUTY COMPLETE LOCK

Capacities to 300 lbs.

Standard Features

- **Complete Locking Mechanism** - Locks both the wheel and the swivel
- **Load Bearings** - Two full independent rows of ball bearings
- **Wheel Bearings** - Are totally sealed
- **Dust Shields** - Upper and lower race

Optional Features

- **Expandable Socket Adapters**
- **Hollow King Pin (Swivel Only)** - Allows for special length bolt to be inserted through open hole in swivel assembly.
- **Swivel without Lock (Prefix CLS)**

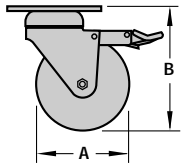

CL-PPB-4



CLR-PPB-4

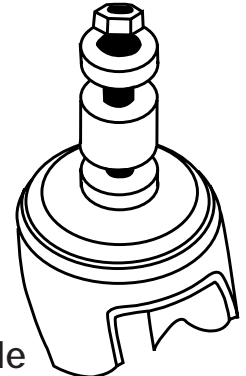

Expandable Stem Selections

Inside Diameter of Tubing	Stem Suffix
3/4" - 15/16" Round or Square	-100
1" - 1 3/16" Round or Square	-125
1 1/4" - 1 1/2" Round or Square	-150
1 9/16" - 1 3/4" Round or Square	-175

Add Expansion Stem Suffix to the swivel part number.

Example CL-SRP-35-100

Standard Top Plate

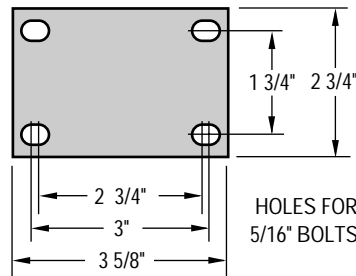

Wheel Specifications					Caster Specifications						Part Number	
Dia. "A" Inches (mm)	Tread Inches (mm)	Wheel Composition	Ref. to Page	Bearing Type	Axle Dia. Inches (mm)	Load Capacity lbs. (KGS)	Overall Height "B" Inches (mm)	Swivel Radius Inches (mm)	Attach. Bolt Inches (mm)	Approx. Shipping Weight lbs. (KGS)	Swivel Complete Lock	Rigid
3 1/2 (89)	1 3/8 (35)	Soft Rubber	73	Self Lube	3/8 (10)	200 (90)	4 29/32 (124)	2 21/32 (74)	5/16 (8)	1.9 (.9)	CL-SRP-35	CLR-SRP-35
		Santoprene (Polyolefin Core)	72	Ball		200 (90)				1.8 (.8)	CL-SPB-35	CLR-SPB-35
		Polyurethane (Polyolefin Core)	72	Delrin		200 (90)				1.8 (.8)	CL-SPD-35	CLR-SPD-35
		Polyurethane (Polyolefin Core)	80	Ball		250 (112)				1.8 (.8)	CL-PPB-35	CLR-PPB-35
		Polyurethane (Polyolefin Core)	80	Delrin		250 (112)				1.8 (.8)	CL-PPD-35	CLR-PPD-35
4 (102)	1 3/8 (35)	Soft Rubber	73	Self Lube	3/8 (10)	200 (90)	5 9/16 (141)	3 7/32 (82)	5/16 (8)	2.2 (1.0)	CL-SRP-4	CLR-SRP-4
		Santoprene (Polyolefin Core)	72	Ball		200 (90)				2.1 (.9)	CL-SPB-4	CLR-SPB-4
		Polyurethane (Polyolefin Core)	72	Delrin		200 (90)				2.1 (.9)	CL-SPD-4	CLR-SPD-4
		Polyurethane (Polyolefin Core)	80	Ball		250 (112)				2.1 (.9)	CL-PPB-4	CLR-PPB-4
		Polyurethane (Polyolefin Core)	80	Delrin		250 (112)				2.1 (.9)	CL-PPD-4	CLR-PPD-4
	1 1/4 (32)	Solid Urethane	77	Plain	275 (124)	2.1 (.9)	CL-KTP-4	CLR-KTP-4				
5 (125)	1 3/8 (35)	Soft Rubber	73	Self Lube	3/8 (10)	200 (90)	6 1/2 (165)	3 23/32 (95)	5/16 (8)	2.9 (1.3)	CL-SRP-5	CLR-SRP-5
		Santoprene (Polyolefin Core)	72	Ball		225 (101)				2.9 (1.3)	CL-SPB-5	CLR-SPB-5
		Polyurethane (Polyolefin Core)	72	Delrin		225 (101)				2.9 (1.3)	CL-SPD-5	CLR-SPD-5
		Polyurethane (Polyolefin Core)	80	Ball		275 (124)				2.9 (1.3)	CL-PPB-5	CLR-PPB-5
		Polyurethane (Polyolefin Core)	80	Delrin		275 (124)				2.9 (1.3)	CL-PPD-5	CLR-PPD-5
	1 1/4 (32)	Solid Urethane	77	Plain	300 (135)	2.9 (1.3)	CL-KTP-5	CLR-KTP-5				

SERIES 05/06 LIGHT MEDIUM DUTY DELUXE

Capacities to 400 lbs.

Standard Features

- **Highest Capacity Rating** - For a Light Medium Duty Caster
- **Load Bearings** - Two independent rows of ball bearings in over-sized, shielded raceways
- **Thread Guards** - On Advanced Elastomer and Neoprene wheels
- **Finish** - Corrosion resistant zinc

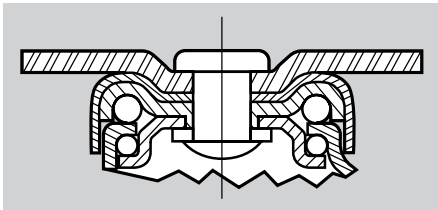

Optional Features

- **Wheel Brakes** - (Suffix -WB)
- **Conductive Wheels** - Advanced Elastomer & Neoprene (Suffix -CDX)
- **Anti-Static Wheels** (Please inquire)
- **Swivel Lock** - (Suffix -SL)

Threaded Stem Selections

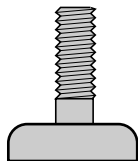

Threaded Stem Size Diameter & Length	Stem Suffix
1/2" x 1 1/2" NC	-TH
5/8" x 2" NC	-TN
3/4" x 2 1/2" NC	-TR

Add the Stem Suffix to the swivel caster part number.

Example 05-NPB-35-TN

Grip Ring Stem Selections

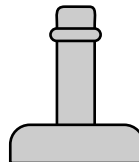

Grip Ring Stem Size Diameter & Length	Stem Suffix
5/8" x 2"	-GU
7/8" x 2"	-GF
1" x 2 1/2"	-GK

APPLICATIONS:

Equipment crates and cases where constant loading and unloading require superior performance.

Professional movers dollies are subjected to abuse beyond the normal application. Like any good tool, the investment in quality is worthwhile.



05-AEB-4



Rigid Caster
06-AEB-4

Top Plate Dimensions & Mounting Hole Spacing

Size of Top Plate (Inches) (mm)	Mounting Hole Spacing (Inches) (mm)	Plate Suffix
3 5/8 x 2 1/2 (92 x 63.5)	3 x 1 3/4 (76 x 44)	Standard
4 3/8 x 3 3/8 (111 x 86)	3 3/8 x 2 3/8 (86 x 60)	P3
4 x 4 (102 x 102)	3 x 3 (76 x 76)	P4

Wheel Specifications						Caster Specifications						Part Number	
Dia. "A" Inches (mm)	Tread Inches (mm)	Wheel Composition	Ref. to Page	Bearing Type	Axle Dia. Inches (mm)	Load Capacity lbs. (KGS)	Overall Height "B" Inches (mm)	Swivel Radius Inches (mm)	Attach. Bolt Inches (mm)	Approx. Shipping Wt.		Swivel Caster	Rigid Caster
										Swivel lbs. (KGS)	Rigid lbs. (KGS)		
3 (75)	1 1/4 (32)	Advanced Elastomer	76	Ball	3/8 (10)	400 (180)	4 5/16 (109)	2 3/4 (70)	5/16 (8)	2.25 (1.0)	2.0 (.90)	05-AEB-3	06-AEB-3
		Neoprene	N/A	Ball		200 (90)				2.25 (1.0)	2.0 (.90)	05-NPB-3	06-NPB-3
		Phenolic	82	Roller		400 (180)				2.25 (1.0)	2.0 (.90)	05-PHR-3	06-PHR-3
	1 3/8 (35)	Polyurethane (Polyolefin Core)	80	Ball		250 (250)				2.25 (1.0)	2.0 (.90)	05-PPB-3	06-PPB-3
3 1/2 (89)	1 1/4 (32)	Advanced Elastomer	76	Ball	3/8 (10)	400 (180)	4 3/4 (121)	3 (75)	5/16 (8)	3.0 (1.4)	2.5 (1.2)	05-AEB-35	06-AEB-35
		Neoprene	N/A	Ball		200 (90)				3.0 (1.4)	2.5 (1.2)	05-NPB-35	06-NPB-35
		Phenolic	82	Roller		400 (180)				3.0 (1.4)	2.5 (1.2)	05-PHR-35	06-PHR-35
	1 3/8 (35)	Polyurethane (Polyolefin Core)	80	Ball		360 (164)				3.0 (1.4)	2.5 (1.2)	05-PPB-35	06-PPB-35
4 (102)	1 1/4 (32)	Advanced Elastomer	76	Ball	3/8 (10)	400 (180)	5 1/4 (133)	3 1/4 (83)	5/16 (8)	3.2 (1.4)	2.7 (1.2)	05-AEB-4	06-AEB-4
		Neoprene	N/A	Ball		200 (90)				3.2 (1.4)	2.7 (1.2)	05-NPB-4	06-NPB-4
		Phenolic	82	Roller		400 (180)				3.2 (1.4)	2.7 (1.2)	05-PHR-4	06-PHR-4
	1 3/8 (35)	Polyurethane (Polyolefin Core)	80	Ball		400 (182)				3.2 (1.4)	2.7 (1.2)	05-PPB-4	06-PPB-4
5 (127)	1 1/4 (32)	Advanced Elastomer	76	Ball	3/8 (10)	400 (180)	6 1/4 (159)	4 3/4 (121)	5/16 (8)	3.5 (1.6)	3.0 (1.4)	05-AEB-5	06-AEB-5
		Neoprene	N/A	Ball		200 (90)				3.5 (1.6)	3.0 (1.4)	05-NPB-5	06-NPB-5
		Phenolic	82	Roller		400 (180)				3.5 (1.6)	3.0 (1.4)	05-PHR-5	06-PHR-5
	1 3/8 (35)	Polyurethane (Polyolefin Core)	80	Ball		400 (182)				3.5 (1.6)	3.0 (1.4)	05-PPB-5	06-PPB-5

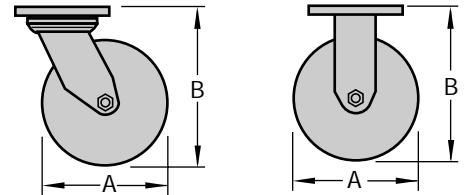

Standard Top Plate

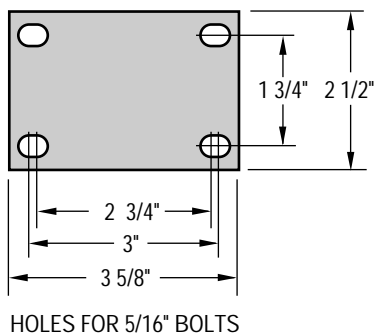

Optional Top Plates

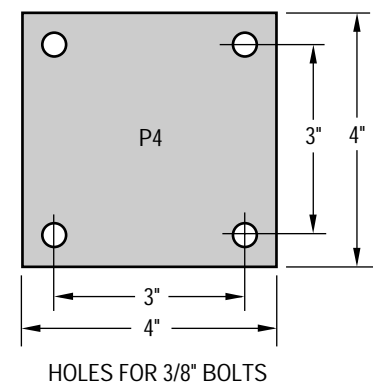
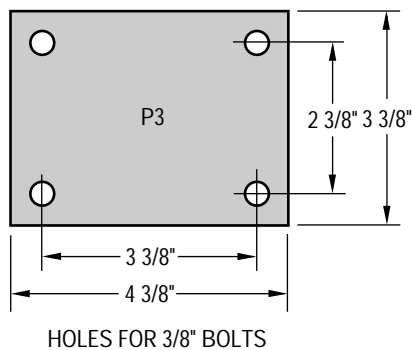

Add the Plate Suffix to the caster part number.
Example 05-NPB-4-P3

SERIES 1 MEDIUM DUTY

Capacities to 600 lbs.

Standard Features

- **Swivel Casters** - Formed legs are continuously welded, top plate is cold forged from $\frac{1}{4}$ " steel and heat treated to relieve stress and add strength

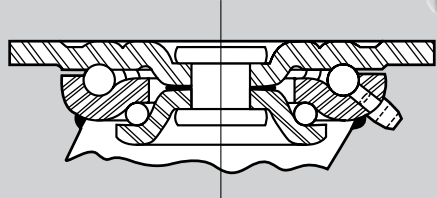

- **Main Load Bearing** - Fully hardened $\frac{5}{16}$ " diameter ball bearings in a hardened raceway provide top performance under maximum rated loads
- **Thrust Bearing** - Large diameter, hardened ball bearings roll freely in a hardened raceway
- **King Pin** - Coined and stress relieved king pin holds raceways precisely in alignment
- **Wheel Bearings** - Roller bearing, or Delrin bearings are available when required
- **Lube Fittings** - Provided for both swivel and wheel bearings when required
- **Finish** - Zinc finish is standard

Standard Top Plate

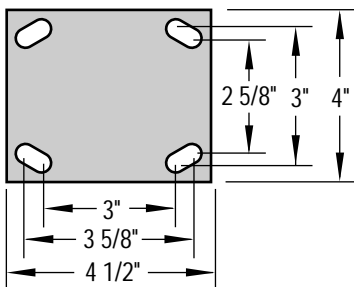

S141R-MR



Optional Features

- **4 Position Swivel Lock** - (Suffix -SL)
- **Delrin Bearing** - (Change R to D)
Example: S141D-PH
- **Wheel Brake, Cam Style** - (Suffix -WB)

Cam Style Brake



APPLICATION:

A good choice where application requires a basic wheel material and capacities of 600 lbs. or less.

The $3 \frac{1}{4}$ " wheel models are particularly well suited for applications where a high capacity is required with an extremely low overall height.



R141R-SS

4 Position Swivel Lock



Wheel Specifications						Caster Specifications						Part Number	
Dia. "A" Inches (mm)	Tread Inches (mm)	Wheel Composition	Ref. to Page	Bearing Type	Axle Dia. Inches (mm)	Load Capacity lbs. (KGS)	Overall Height "B" Inches (mm)	Swivel Radius Inches (mm)	Attach. Bolt Inches (mm)	Approx. Shipping Wt.		Swivel Caster	Rigid Caster
										Swivel lbs. (KGS)	Rigid lbs. (KGS)		
3 1/4 (83)	1 1/2 (38)	Cast Iron	86	Roller	1/2 (13)	600 (270)	4 1/4 (108)	1 3/4 (44)	3/8 (10)	4.5 (2.0)	4.0 (1.8)	S131R-SS	R131R-SS
		Phenolic	82	Roller		600 (270)				3.0 (1.4)	2.5 (1.13)	S131R-PH	R131R-PH
		Mold-on Rubber (Cast Iron Core)	74	Roller		240 (108)				4.5 (2.0)	4.0 (2.8)	S131R-MR	R131R-MR
		Polyurethane (Cast Iron Core)	78	Roller		500 (225)				4.5 (2.0)	4.0 (1.8)	S131R-PI	R131R-PI
4 (102)	1 1/2 (38)	Cast Iron	86	Roller	1/2 (13)	550 (248)	5 5/8 (143)	3 5/8 (92)	3/8 (10)	5.0 (2.3)	4.5 (2.0)	S141R-SS	R141R-SS
		Phenolic	82	Roller		600 (270)				3.5 (1.6)	3.0 (1.4)	S141R-PH	R141R-PH
		Mold-on Rubber (Cast Iron Core)	74	Roller		250 (113)				5.0 (2.3)	4.5 (2.0)	S141R-MR	R141R-MR
		Polyurethane (Cast Iron Core)	78	Roller		400 (180)				5.0 (2.3)	4.5 (2.0)	S141R-PI	R141R-PI
		Polyolefin (Blk)	81	Roller		400 (180)				3.5 (1.6)	3.0 (1.4)	S141R-PB	R141R-PB
		Polyolefin (Wt)	81	Delrin		350 (157)				3.5 (1.6)	3.0 (1.4)	S141D-PW	R141D-PW
5 (127)	1 1/2 (38)	Cast Iron	86	Roller	1/2 (13)	600 (270)	6 1/2 (165)	4 1/2 (108)	3/8 (10)	5.5 (2.5)	5.0 (2.3)	S151R-SS	R151R-SS
		Phenolic	82	Roller		600 (270)				4.0 (1.8)	3.5 (1.6)	S151R-PH	R151R-PH
		Mold-on Rubber (Cast Iron Core)	74	Roller		250 (113)				5.5 (2.5)	5.0 (2.3)	S151R-MR	R151R-MR
		Polyurethane (Cast Iron Core)	78	Roller		450 (202)				5.5 (2.5)	5.0 (2.3)	S151R-PI	R151R-PI
		Polyolefin (Blk)	81	Roller		450 (202)				4.0 (1.8)	3.5 (1.6)	S151R-PB	R151R-PB
		Polyolefin (Wt)	81	Delrin		400 (180)				4.0 (1.8)	3.5 (1.6)	S151D-PW	R151D-PW
6 (152)	1 1/2 (38)	Cast Iron	86	Roller	1/2 (13)	600 (270)	7 1/2 (191)	5 (127)	3/8 (10)	6.5 (2.9)	6.0 (2.7)	S161R-SS	R161R-SS
		Phenolic	82	Roller		600 (270)				5.5 (2.5)	5.0 (2.3)	S161R-PH	R161R-PH
		Mold-on Rubber (Cast Iron Core)	74	Roller		300 (135)				6.5 (2.9)	6.0 (2.7)	S161R-MR	R161R-MR
		Polyurethane (Cast Iron Core)	78	Roller		550 (248)				6.5 (2.9)	6.0 (2.7)	S161R-PI	R161R-PI
		Polyolefin (Blk)	81	Roller		450 (202)				5.5 (2.5)	5.0 (2.3)	S161R-PB	R161R-PB
		Polyolefin (Wt)	81	Delrin		400 (180)				5.5 (2.5)	5.0 (2.3)	S161D-PW	R161D-PW

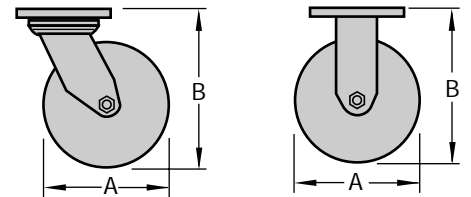

SERIES 1 MEDIUM HEAVY DUTY

Capacities to 1200 lbs.

Standard Features

- **Swivel Casters** - Formed legs are continuously welded, top plate is cold forged from 1/4" steel and heat treated to relieve stress and add strength
- **Main Load Bearing** - Fully hardened 5/16" diameter ball bearings in a hardened raceway provide top performance under maximum rated loads
- **Thrust Bearing** - Large diameter hardened ball bearings roll freely in a hardened raceway

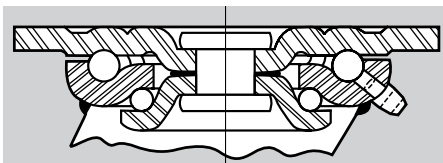

- **King Pin** - 3/4" Coined and stress relieved king pin holds raceways precisely in alignment
- **Wheel Bearings** - Roller bearings are available standard for all wheel sizes
- **Finish** - Corrosion resistant zinc



S182R-SP



R162R-PB



- **Pre-Notched raceway** for field installable Swivel Lock
- **Lube Fittings** - Provided for both swivel and wheel bearings

Optional Features

- **Swivel Bearing Grease Seals** - (Suffix -GS)
- **Delrin Bearing** - (Change R to D)
Example: S162D-PH
- **4 Position Swivel Lock** - (Suffix -SL)
(plunger only part No.1SL-N)
- **Top Locking Wheel Brake** - (Suffix -TLB)
Available on 4", 5", 6" and 8" diameters. See page 104

- **Wheel Brake** - (Suffix -WB)
 - 4" to 8" Swivel Brake - Tread contact type. Brake shoe grips across and into tread for secure hold: field installable (see price list for brake kit)
 - 3 1/4" Swivel Brake - Cam style. This brake utilizes a larger lever for effective cam action locking of the wheel. This style brake may also be adapted to rigid casters. Not field installable. (See page 104)

Wheel Specifications					Caster Specifications						Part Number		
Dia. "A" Inches (mm)	Tread Inches (mm)	Wheel Composition	Ref. to Page	Bearing Type	Axle Dia. Inches (mm)	Load Capacity lbs. (KGS)	Overall Height "B" Inches (mm)	Swivel Radius Inches (mm)	Attach. Bolt Inches (mm)	Approx. Shipping Wt.		Swivel Caster	Rigid Caster
										Swivel lbs. (KGS)	Rigid lbs. (KGS)		
3 1/4 (82)	2 (50)	Cast Iron	86	Roller	1/2 (13)	700 (315)	4 1/4 (108)	3 3/8 (86)	3/8 (10)	7.4 (3.3)	6.9 (3.2)	S132R-SS	R132R-SS
		Phenolic	82	Roller		700 (315)				5.5 (2.5)	5.0 (2.3)	S132R-PH	R132R-PH
		Mold-on Rubber (Cast Iron Core)	74	Roller		240 (108)				7.4 (3.3)	6.9 (3.2)	S132R-MR	R132R-MR
		Polyurethane (Steel Core)	78	Roller		500 (225)				7.4 (3.3)	6.9 (3.2)	S132R-PI	R132R-PI
4 (102)	2 (50)	Cast Iron	86	Roller	1/2 (13)	800 (360)	5 5/8 (143)	3 3/4 (92)	3/8 (10)	8.5 (3.8)	8.0 (3.6)	S142R-SS	R142R-SS
		Phenolic	82	Roller		800 (360)				6.0 (2.7)	5.5 (2.5)	S142R-PH	R142R-PH
		Mold-on Rubber (Cast Iron Core)	74	Roller		350 (157)				8.5 (3.8)	8.0 (3.6)	S142R-MR	R142R-MR
		Polyurethane (Cast Iron Core)	78	Roller		700 (315)				8.5 (3.8)	8.0 (3.6)	S142R-PI	R142R-PI
		Polyurethane (Alum. Core)	75	Roller		800 (360)				6.5 (2.9)	6.0 (2.7)	S142R-PA	R142R-PA
		Solid Urethane	77	Roller		700 (315)				6.5 (2.9)	6.0 (2.7)	S142R-KT	R142R-KT
		Polyurethane (Polyolefin Core)	80	Roller		700 (315)				6.0 (2.7)	5.5 (2.5)	S142R-PP	R142R-PP
		Polyolefin (Blk)	81	Roller		450 (202)				5.5 (2.5)	5.0 (2.3)	S142R-PB	R142R-PB
	Polyolefin (Wt)	81	Delrin	450 (202)	5.5 (2.5)	5.0 (2.3)	S142D-PW	R142D-PW					
	1 1/2 (38)	Forged Steel	88	Roller	900 (405)	8.5 (3.8)	8.0 (3.6)	S141R-FS	R141R-FS				

Wheel Specifications						Caster Specifications						Part Number	
Dia. "A" Inches (mm)	Tread Inches (mm)	Wheel Composition	Ref. to Page	Bearing Type	Axle Dia. Inches (mm)	Load Capacity lbs. (KGS)	Overall Height "B" Inches (mm)	Swivel Radius Inches (mm)	Attach. Bolt Inches (mm)	Approx. Shipping Wt.		Swivel Caster	Rigid Caster
										Swivel lbs. (KGS)	Rigid lbs. (KGS)		
5 (127)	2 (50)	Cast Iron	86	Roller	1/2 (13)	900 (405)	6 1/2 (165)	4 1/4 (108)	3/8 (10)	8.8 (4.0)	8.3 (3.7)	S152R-SS	R152R-SS
		Phenolic	82	Roller		900 (405)				6.5 (3.0)	6.0 (2.7)	S152R-PH	R152R-PH
		Mold-on Rubber (Cast Iron Core)	74	Roller		400 (180)				8.8 (4.0)	8.3 (3.7)	S152R-MR	R152R-MR
		Polyurethane (Cast Iron Core)	78	Roller		900 (405)				8.8 (4.0)	8.3 (3.7)	S152R-PI	R152R-PI
		Polyurethane (Alum. Core)	75	Roller		900 (405)				7.0 (3.2)	6.5 (3.0)	S152R-PA	R152R-PA
		Solid Urethane	77	Roller		900 (405)				7.0 (3.2)	6.5 (3.0)	S152R-KT	R152R-KT
		Polyurethane (Polyolefin Core)	80	Roller		750 (337)				6.5 (3.0)	6.0 (2.7)	S152R-PP	R152R-PP
		Santoprene (Polyolefin Core)	72	Roller		450 (202)				6.5 (3.0)	6.0 (2.7)	S152R-SP	R152R-SP
		Polyolefin (Blk)	81	Roller		650 (292)				6.0 (2.7)	5.5 (2.5)	S152R-PB	R152R-PB
		Polyolefin (Wt)	81	Delrin		600 (270)				6.0 (2.7)	5.5 (2.5)	S152D-PW	R152D-PW
		Forged Steel	88	Roller		1200 (540)				8.8 (4.0)	8.3 (3.7)	S152R-FS	R152R-FS
6 (152)	2 (50)	Cast Iron	86	Roller	1/2 (13)	900 (405)	7 1/4 (184)	5 (127)	3/8 (10)	9.0 (4.1)	8.5 (3.6)	S162R-SS	R162R-SS
		Phenolic	82	Roller		900 (405)				7.0 (3.2)	6.0 (2.7)	S162R-PH	R162R-PH
		Mold-on Rubber (Cast Iron Core)	74	Roller		410 (184)				9.0 (4.1)	8.0 (3.6)	S162R-MR	R162R-MR
		Polyurethane (Cast Iron Core)	78	Roller		900 (405)				9.0 (4.1)	8.0 (3.6)	S162R-PI	R162R-PI
		Polyurethane (Alum. Core)	75	Roller		900 (405)				7.5 (3.4)	6.5 (2.9)	S162R-PA	R162R-PA
		Solid Urethane	77	Roller		900 (405)				7.5 (3.4)	6.5 (2.9)	S162R-KT	R162R-KT
		Polyurethane (Polyolefin Core)	80	Roller		900 (405)				7.0 (3.2)	6.0 (2.7)	S162R-PP	R162R-PP
		Santoprene (Polyolefin Core)	72	Roller		550 (247)				7.0 (3.2)	6.0 (2.7)	S162R-SP	R162R-SP
		Polyolefin (Blk)	81	Roller		700 (315)				6.5 (2.9)	5.5 (2.5)	S162R-PB	R162R-PB
		Polyolefin (Wt)	81	Delrin		650 (292)				6.5 (2.9)	5.5 (2.5)	S162D-PW	R162D-PW
		Forged Steel	88	Roller		1200 (540)				9.3 (4.2)	8.3 (3.7)	S162R-FS	R162R-FS
8 (203)	2 (50)	Cast Iron	86	Roller	1/2 (13)	1050 (473)	9 1/2 (241)	6 1/8 (156)	3/8 (10)	12.0 (5.4)	11.0 (5.0)	S182R-SS	R182R-SS
		Phenolic	82	Roller		900 (405)				8.5 (3.8)	7.5 (3.4)	S182R-PH	R182R-PH
		Mold-on Rubber (Cast Iron Core)	74	Roller		500 (225)				10.5 (4.5)	9.0 (4.1)	S182R-MR	R182R-MR
		Polyurethane (Cast Iron Core)	78	Roller		900 (405)				10.5 (4.7)	9.5 (4.3)	S182R-PI	R182R-PI
		Polyurethane (Alum. Core)	75	Roller		900 (405)				8.0 (3.6)	7.0 (3.2)	S182R-PA	R182R-PA
		Solid Urethane	77	Roller		1000 (450)				8.5 (3.8)	7.5 (3.4)	S182R-KT	R182R-KT
		Polyurethane (Polyolefin Core)	80	Roller		900 (405)				7.5 (3.4)	6.5 (2.9)	S182R-PP	R182R-PP
		Santoprene (Polyolefin Core)	72	Roller		700 (315)				7.5 (3.4)	6.5 (2.9)	S182R-SP	R182R-SP
		Polyolefin (Blk)	81	Roller		800 (360)				6.5 (2.9)	5.5 (2.5)	S182R-PB	R182R-PB
		Polyolefin (Wt)	81	Delrin		700 (315)				6.5 (2.9)	5.5 (2.5)	S182D-PW	R182D-PW

Standard Top Plate #1

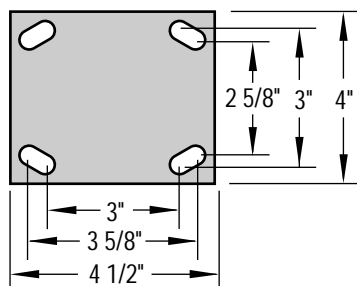

Optional Top Plate #2

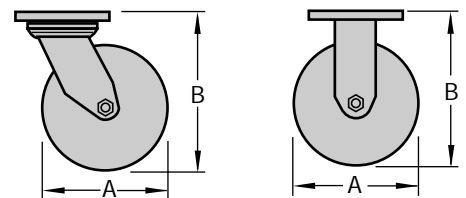
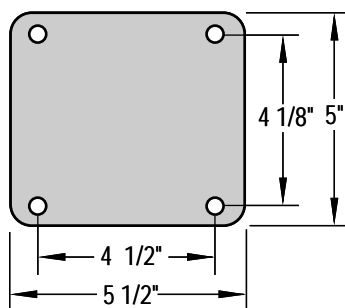

(Change 2nd character in part number)
Example: S262R-PH

SERIES KP1 KINGPIN-FREE MED HEAVY DUTY

Capacities to 1,500 lbs.

Standard Features

- **Top Plate** - High strength alloy steel 1-piece forging
- **Yoke Base** - Precision machined and hardened for extended life

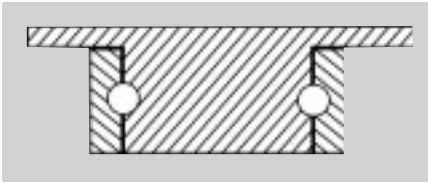

- **Swivel Assembly** - $\frac{3}{8}$ " ball bearing mounted in a 2" precision machined raceway hardened to 50 Rockwell C
- **Legs** - $\frac{1}{4}$ " steel formed to increase strength and welded to yoke base
- **Axle** - $\frac{1}{2}$ " diameter
- **Wheel bearings** - straight roller bearing standard
- **Finish** Corrosion Resistant Zinc

Optional Features

- **Wheel Brake Cam Style** (Suffix -WB)
- **4-Position Swivel Lock** (Suffix -SL)
- **Sealed Swivel Assembly** (Suffix -SS)
- **Powder Coating** (Call Factory)
- **Thread Guards** (Suffix -TG)
- **Delrin Bearing** (Change R to D)
Example: SKP162D -PH



APPLICATIONS:

Kingpin-Free Casters have rugged one-piece forged steel top plate which eliminates the two-piece weldment that can separate causing failure of the competitive models. This caster was designed for shock loading applications and any area where a rugged, durable caster is needed.



Standard Top Plate #1

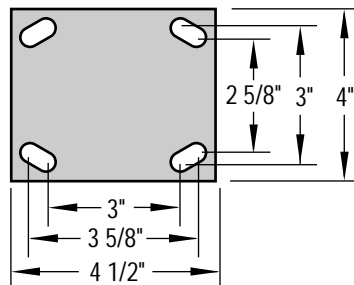

Optional Top Plate #3

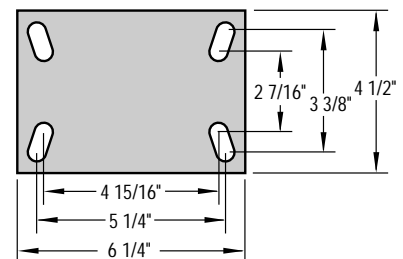

Wheel Specifications					Caster Specifications						Part Number		
Dia. "A" Inches (mm)	Tread Inches (mm)	Wheel Composition	Ref. to Page	Bearing Type	Axle Dia. Inches (mm)	Load Capacity lbs. (KGS)	Overall Height "B" Inches (mm)	Swivel Radius Inches (mm)	Attach. Bolt Inches (mm)	Approx. Shipping Wt.		Swivel Caster	Rigid Caster
										Swivel lbs. (KGS)	Rigid lbs. (KGS)		
4 (102)	2 (50)	Cast Iron	86	Roller	1/2 (13)	800 (360)	5 5/8 (143)	3 11/16 (94)	1/2 (13)	8.5 (3.8)	7.5 (3.4)	SKP142R-SS	RKP142R-SS
		Phenolic	82	Roller		800 (360)				6.0 (2.7)	5.0 (2.5)	SKP142R-PH	RKP142R-PH
		Mold-on Rubber	74	Roller		350 (157)				8.5 (3.8)	7.5 (3.4)	SKP142R-MR	RKP142R-MR
		Polyurethane (Cast Iron Core)	78	Roller		700 (315)				8.5 (3.8)	7.5 (3.4)	SKP142R-PI	RKP142R-PI
		Polyurethane (Aluminum Core)	75	Roller		700 (315)				7.0 (3.2)	6.0 (2.7)	SKP142R-PA	RKP142R-PA
		Solid Urethane	77	Roller		700 (315)				6.5 (3.0)	5.5 (2.5)	SKP142R-KT	RKP142R-KT
		Polyurethane (Polyolefin Core)	80	Roller		700 (315)				6.0 (2.7)	5.0 (2.5)	SKP142R-PP	RKP142R-PP
		Polyolefin	81	Roller		450 (202)				6.0 (2.7)	5.0 (2.5)	SKP142R-PB	RKP142R-PB
	1 1/2 (38)	Forged Steel	88	Roller	1400 (630)	8.0 (3.6)	7.0 (3.2)	SKP141R-FS	RKP141R-FS				
	5 (127)	2 (50)	Cast Iron	86	Roller	1/2 (13)	900 (405)	6 1/2 (165)	4 3/16 (106)	1/2 (13)	8.8 (4.0)	8.3 (3.7)	SKP152R-SS
Phenolic			82	Roller	900 (405)		6.5 (3.0)				6.0 (2.7)	SKP152R-PH	RKP152R-PH
Mold-on Rubber (Cast Iron Core)			74	Roller	400 (180)		8.8 (4.0)				8.3 (3.7)	SKP152R-MR	RKP152R-MR
Polyurethane (Cast Iron Core)			78	Roller	900 (405)		8.8 (4.0)				8.3 (3.7)	SKP152R-PI	RKP152R-PI
Polyurethane (Aluminum Core)			75	Roller	900 (405)		7.0 (3.2)				6.5 (3.0)	SKP152R-PA	RKP152R-PA
Solid Urethane			77	Roller	900 (405)		7.0 (3.2)				6.5 (3.0)	SKP152R-KT	RKP152R-KT
Polyurethane (Polyolefin Core)			80	Roller	750 (340)		6.5 (3.0)				6.0 (2.7)	SKP152R-PP	RKP152R-PP
Polyolefin			81	Roller	650 (300)		6.0 (2.7)				5.5 (2.5)	SKP152R-PB	RKP152R-PB
Forged Steel		88	Roller	1100 (500)	8.8 (4.0)	8.3 (3.7)	SKP152R-FS	RKP152R-FS					
6 (152)	2 (50)	Cast Iron	86	Roller	1/2 (13)	1000 (850)	7 1/2 (191)	4 5/8 (118)	1/2 (13)	9.0 (4.1)	8.5 (3.6)	SKP162R-SS	RKP162R-SS
		Phenolic	82	Roller		1000 (450)				7.0 (3.2)	6.0 (2.7)	SKP162R-PH	RKP162R-PH
		Mold-on Rubber (Cast Iron Core)	74	Roller		410 (184)				9.0 (4.1)	8.0 (3.6)	SKP162R-MR	RKP162R-MR
		Polyurethane (Cast Iron Core)	78	Roller		1000 (450)				9.0 (4.1)	8.0 (3.6)	SKP162R-PI	RKP162R-PI
		Polyurethane (Aluminum Core)	75	Roller		1000 (450)				7.5 (3.4)	6.5 (2.9)	SKP162R-PA	RKP162R-PA
		Solid Urethane	77	Roller		1000 (450)				7.5 (3.4)	6.5 (2.9)	SKP162R-KT	RKP162R-KT
		Polyurethane (Polyolefin Core)	80	Roller		700 (315)				7.0 (3.2)	6.0 (2.7)	SKP162R-PP	RKP162R-PP
		Polyolefin	81	Roller		650 (300)				6.5 (2.9)	5.5 (2.5)	SKP162R-PB	RKP162R-PB
	Forged Steel	88	Roller	1500 (675)	9.3 (4.2)	8.3 (3.7)	SKP162R-FS	RKP162R-FS					
8 (203)	2 (50)	Cast Iron	86	Roller	1/2 (13)	1000 (450)	10 1/8 (257)	5 3/4 (146)	1/2 (13)	12.0 (5.4)	11.0 (5.0)	SKP182R-SS	RKP182R-SS
		Phenolic	82	Roller		1000 (450)				8.5 (3.8)	7.5 (3.4)	SKP182R-PH	RKP182R-PH
		Mold-on Rubber (Cast Iron Core)	74	Roller		500 (225)				10.5 (4.5)	9.0 (4.1)	SKP182R-MR	RKP182R-MR
		Polyurethane (Cast Iron Core)	78	Roller		1500 (450)				10.5 (4.5)	9.5 (4.3)	SKP182R-PI	RKP182R-PI
		Polyurethane (Aluminum Core)	75	Roller		1000 (450)				8.0 (3.6)	7.0 (3.2)	SKP182R-PA	RKP182R-PA
		Solid Urethane	77	Roller		1000 (450)				8.5 (3.8)	7.5 (3.4)	SKP182R-KT	RKP182R-KT
		Polyurethane (Polyolefin Core)	80	Roller		900 (405)				7.5 (3.4)	6.5 (2.9)	SKP182R-PP	RKP182R-PP
		Polyolefin	81	Roller		700 (315)				6.5 (2.9)	5.5 (2.5)	SKP182R-PB	RKP182R-PB

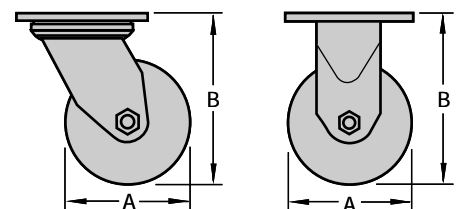

SERIES KP7 KINGPIN-FREE HEAVY DUTY

Capacities to 5,500 lbs.

Standard Features

- **Top Plate/Yoke Base** - AISI-1045 Steel one piece forging precision machined and hardened. $\frac{3}{8}$ " Top Plate Thickness
- **Yoke Base** - is pre-notched for field installable swivel lock

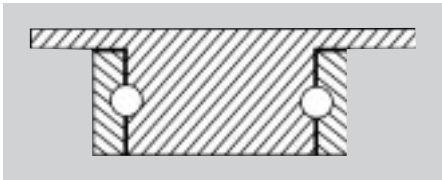

- **Swivel Assembly** - $\frac{1}{2}$ " ball bearing mounted in a 3" precision machined raceway
- **Legs** - $\frac{3}{8}$ " steel welded to base inside and out
- **Axle** - $\frac{3}{4}$ " diameter

Optional Features

- **Bolt On Swivel Lock** (Suffix-SL)
Can be ordered separately
(Part No. KPL-SL)
- **Wheel Brake Options**
Face Contact Brake (Suffix-FCB)
Thumb Screw Brake (Suffix-WB)

Standard Top Plate

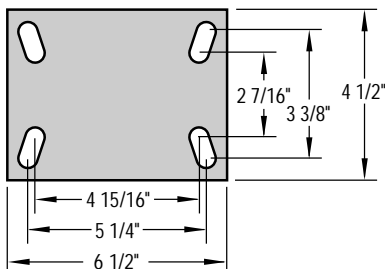

APPLICATIONS:

Constructed to withstand shock loads, This uniquely manufactured product is suitable for all heavy duty requirements. Kingpin-Free swivel assembly is designed for maintenance free service.



SKP763R-PI



RKP763R-PI

Wheel Specifications					Caster Specifications						Part Number		
Dia. "A" Inches (mm)	Tread Inches (mm)	Wheel Composition	Ref. to Page	Bearing Type	Axle Dia. Inches (mm)	Load Capacity lbs. (KGS)	Overall Height "B" Inches (mm)	Swivel Radius Inches (mm)	Attach. Bolt Inches (mm)	Approx. Shipping Wt.		Swivel Caster	Rigid Caster
										Swivel lbs. (KGS)	Rigid lbs. (KGS)		
6 (152)	3 (76)	Cast Iron	86	Roller	3/4 (19)	2000 (900)	7 1/2 (190)	4 1/2 (114)	1/2 (13)	23.0 (10.3)	10.5 (4.7)	SKP763R-SS	RKP763R-SS
		Phenolic	82	Roller		2000 (900)				15.0 (6.8)	6.75 (3.0)	SKP763R-PH	RKP763R-PH
		Mold-on Rubber (Cast Iron Core)	74	Roller		540 (240)				20.0 (9.0)	9.0 (4.0)	SKP763R-MR	RKP763R-MR
		Polyurethane (Iron Core)	78	Roller		2000 (900)				21.0 (9.5)	9.5 (4.3)	SKP763R-PI	RKP763R-PI
		Severe Duty Polyurethane	79	Tapered Roller		2500 (1100)				24.0 (10.5)	13.0 (6.0)	SKP763T-PA	RKP763T-PS
	2 1/2 (60)	Solid Urethane	77	Prec. Ball		2000 (900)				15.0 (6.8)	10.0 (4.5)	SKP7625B-SKT	RKP7625B-SKT
	Forged Steel	88	Roller	5000 (2250)		21.0 (9.5)				9.5 (4.3)	SKP7625R-FS	RKP7625R-FS	
8 (203)	3 (76)	Cast Iron	86	Roller	1/2 (13)	2500 (1100)	10 1/8 (257)	6 1/4 (159)	1/2 (13)	24.0 (10.5)	11.5 (5.0)	SKP783R-SS	RKP783R-SS
		Phenolic		Roller		2500 (1100)				19.0 (6.8)	8.5 (3.0)	SKP783R-PH	RKP783R-PH
		Mold-on Rubber (Cast Iron Core)	82	Roller		670 (240)				21.0 (9.0)	9.5 (4.0)	SKP783R-MR	RKP783R-MR
		Polyurethane (Iron Core)	74	Roller		2500 (900)				23.0 (9.5)	10.5 (4.3)	SKP783R-PI	RKP783R-PI
		Severe Duty Polyurethane	79	Tapered Roller		2500 (1100)				25.0 (10.5)	11.5 (6.0)	SKP783T-PS	RKP783T-PS
	2 1/2 (60)	Solid Urethane	77	Prec. Ball		2000 (900)				19.0 (6.8)	8.5 (4.5)	SKP7825B-SKT	RKP7825B-SKT
	Forged Steel	88	Roller	4000 (2250)		23.0 (9.5)				10.5 (4.3)	SKP7825R-FS	RKP7825R-FS	
10 (254)	3 (76)	Cast Iron	86	Roller	1/2 (13)	2500 (1100)	11 1/2 (292)	7 1/2 (190)	3/8 (10)	27.0 (12.2)	12.0 (5.4)	SKP7103R-SS	RKP7103R-SS
		Phenolic	82	Roller		2500 (1100)				21.0 (9.5)	9.5 (4.3)	SKP7103R-PH	RKP7103R-PH
		Mold-on Rubber (Cast Iron Core)	74	Roller		1000 (450)				23.0 (10.4)	10.5 (4.7)	SKP7103R-MR	RKP7103R-MR
		Polyurethane (Iron Core)	78	Roller		2500 (1100)				28.0 (12.6)	12.5 (5.6)	SKP7103R-PI	RKP7103R-PI
		Severe Duty Polyurethane	79	Tapered Roller		3000 (1350)				30.0 (13.5)	14.5 (6.5)	SKP7103T-PS	RKP7103T-PS
		Solid Urethane	77	Prec. Ball		2500 (1100)				21.0 (9.5)	9.5 (4.3)	SKP7103B-SKT	RKP7103B-SKT
		Forged Steel	88	Roller		4600 (2000)				28.0 (12.6)	12.5 (5.6)	SKP7103R-FS	RKP7103R-FS
12 (305)	3 (76)	Cast Iron	86	Roller	1/2 (13)	2500 (1100)	13 1/2 (343)	9 (228)	1/2 (13)	32.0 (14.4)	14.5 (6.5)	SKP7123R-SS	RKP7123R-SS
		Phenolic	82	Roller		3500 (1500)				24.0 (10.8)	11.0 (5.0)	SKP7123R-PH	RKP7123R-PH
		Mold-on Rubber (Cast Iron Core)	74	Roller		1140 (500)				30.0 (13.5)	13.5 (6.1)	SKP7123R-MR	RKP7123R-MR
		Polyurethane (Iron Core)	78	Roller		3500 (1500)				35.0 (15.8)	16.0 (7.2)	SKP7123R-PI	RKP7123R-PI
		Severe Duty Polyurethane	79	Tapered Roller		3500 (1500)				37.0 (16.8)	18.0 (8.2)	SKP7123T-PS	RKP7123T-PS
		Solid Urethane	77	Prec. Ball		3000 (1350)				30.0 (13.5)	13.5 (6.1)	SKP7123B-SKT	RKP7123B-SKT

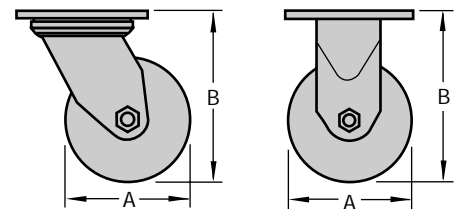

SERIES KP8 KINGPIN-FREE HEAVY DUTY

Capacities to 5,000 lbs.

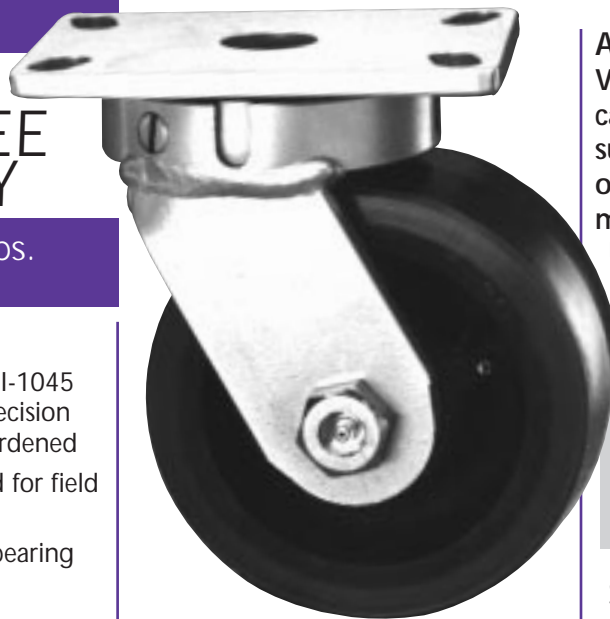

Standard Features

- **Top Plate/Yoke Base** - AISI-1045 Steel one piece forging precision machined and through hardened
- **Yoke Base** - is pre-notched for field installable swivel lock
- **Swivel Section** - 1/2" ball bearing mounted in a 3" precision machined raceway
- **Legs** - 3/8" steel welded to yoke base using 100,000 PSI weld filler, welded inside and out
- **Axle** - 3/4" diameter

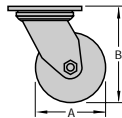

Optional Features

- **Bolt On Swivel Lock** (Suffix -SL)
Can be ordered separately (Part No. KP7-SL)
- **Wheel Brake Options**
Face Contact Brake (Suffix -FCB)
Thumb Screw Brake (Suffix -WB)

APPLICATIONS:

Virtually all equipment where capacities require a caster of superior construction. In plant operations will benefit from low maintenance service for life.

Unlike similar designs, the one-piece top plate/yoke base adds a measure of safety by eliminating a weldment.

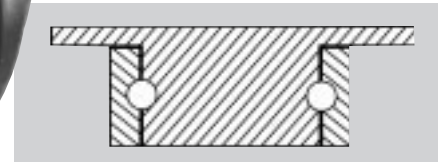

Standard Top Plate

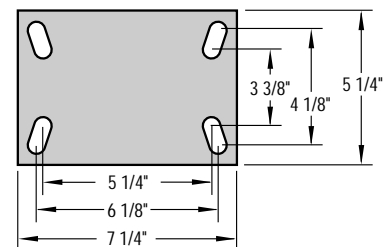

Wheel Specifications					Caster Specifications						Part Number		
Dia. "A" Inches (mm)	Tread Inches (mm)	Wheel Composition	Ref. to Page	Bearing Type	Axle Dia. Inches (mm)	Load Capacity lbs. (KGS)	Overall Height "B" Inches (mm)	Swivel Radius Inches (mm)	Attach. Bolt Inches (mm)	Approx. Shipping Wt.		Swivel Caster	Rigid Caster
										Swivel lbs. (KGS)	Rigid lbs. (KGS)		
6 (152)	3 (76)	Cast Iron	86	Roller	3/4 (19)	2000 (900)	8 (203)	4 1/2 (114)	1/2 (13)	26.0 (11.7)	20.5 (9.0)	SKP863R-SS	RKP863R-SS
		Phenolic	82	Roller		2000 (900)				18.0 (8.1)	12.0 (5.4)	SKP863R-PH	RKP863R-PH
		Mold-on Rubber (Cast Iron Core)	74	Roller		540 (240)				20.0 (9.0)	14.0 (6.3)	SKP863R-MR	RKP863R-MR
		Polyurethane (Iron Core)	78	Roller		2000 (900)				20.0 (9.0)	14.0 (6.3)	SKP863R-PI	RKP863R-PI
		Severe Duty Polyurethane	79	Tapered Roller		2500 (1100)				22.0 (9.9)	18.0 (7.2)	SKP863T-PS	RKP863T-PS
	2 1/2 (60)	Solid Urethane	77	Prec. Ball		2000 (900)				18.0 (8.1)	12.0 (5.4)	SKP8625B-SKT	RKP8625B-SKT
		Forged Steel	88	Roller		5000 (2250)				26.0 (11.7)	20.5 (10.4)	SKP8625R-FS	RKP8625R-FS
		8 (203)	3 (76)	Cast Iron		86				Roller	2500 (1100)	10 1/2 (267)	6 1/4 (159)
Phenolic	82			Roller	2500 (1100)	20.0 (9.0)	17.0 (6.9)	SKP883R-PH	RKP883R-PH				
Mold-on Rubber (Cast Iron Core)	74			Roller	670 (300)	22.0 (9.9)	19.0 (8.6)	SKP883R-MR	RKP883R-MR				
Polyurethane (Iron Core)	78			Roller	2500 (1100)	22.0 (9.9)	19.5 (8.6)	SKP883R-PI	RKP883R-PI				
Severe Duty Polyurethane	79			Tapered Roller	2500 (1100)	26.0 (11.7)	23.0 (10.4)	SKP883T-PS	RKP883T-PS				
2 1/2 (60)	Solid Urethane		77	Prec. Ball	2000 (900)	20.0 (9.0)	17.5 (6.9)	SKP8825B-SKT	RKP8825B-SKT				
	Forged Steel		88	Roller	4000 (1800)	32.0 (14.4)	29.5 (13.0)	SKP8825R-FS	RKP8825R-FS				
	10 (254)		3 (76)	Cast Iron	86	Roller	2500 (1100)	12 1/2 (317)	7 1/2 (190)	1/2 (13)	35.0 (15.8)		
Phenolic		82		Roller	2500 (1100)	28.0 (12.6)	22.5 (9.9)				SKP8103R-PH	RKP8103R-PH	
Mold-on Rubber (Cast Iron Core)		74		Roller	1000 (900)	31.0 (14.0)	25.0 (11.3)				SKP8103R-MR	RKP8103R-MR	
Polyurethane (Iron Core)		78		Roller	2500 (1100)	36.0 (16.2)	30.0 (140)				SKP8103R-PI	RKP8103R-PI	
Severe Duty Polyurethane		79		Tapered Roller	3000 (1350)	37.0 (16.7)	31.5 (148)				SKP8103T-PS	RKP8103T-PS	
Solid Urethane		77	Prec. Ball	2500 (1100)	28.0 (12.6)	22.0 (9.9)	SKP8103B-SKT				RKP8103B-SKT		
		Forged Steel	88	Roller	4600 (2000)	38.0 (17.1)	31.0 (140)				SKP8103R-FS	RKP8103R-FS	
		12 (305)	3 (76)	Cast Iron	86	Roller	2500 (1100)				15 1/2 (394)	9 (228)	1/2 (13)
Phenolic	82			Roller	3500 (1500)	32.0 (14.4)	28.0 (12.6)	SKP8123R-PH	RKP8123R-PH				
Mold-on Rubber (Cast Iron Core)	74			Roller	1140 (500)	37.0 (16.7)	31.0 (140)	SKP8123R-MR	RKP8123R-MR				
Polyurethane (Iron Core)	78			Roller	3500 (1500)	41.0 (18.5)	35.0 (15.8)	SKP8123R-PI	RKP8123R-PI				
Severe Duty Polyurethane	79			Tapered Roller	3500 (1500)	41.0 (18.5)	35.0 (15.8)	SKP8123T-PS	RKP8123T-PS				
Solid Urethane	77			Prec. Ball	3000 (1350)	32.0 (14.4)	28.0 (12.6)	SKP8123B-SKT	RKP8123B-SKT				

SERIES KP11 KINGPIN-FREE HEAVY DUTY

Capacities to 7,700 lbs.

Standard Features

- **Top Plate/Yoke Base** - AISI-1045 Steel one piece forging precision machined and through hardened. 1/2" top plate thickness
- **Yoke Base** - is pre-notched for field installable swivel lock

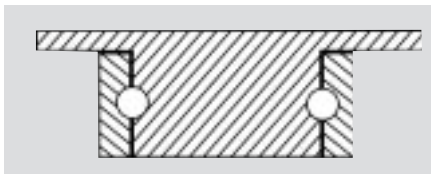

- **Swivel Section** - 3/4" ball bearings mounted in a 4 1/2" diameter precision raceway
- **Legs** - 3/8" formed steel to increase strength and welded to yoke base using 100,000 PSI weld filler, welded inside and out
- **Axle** - 1" diameter

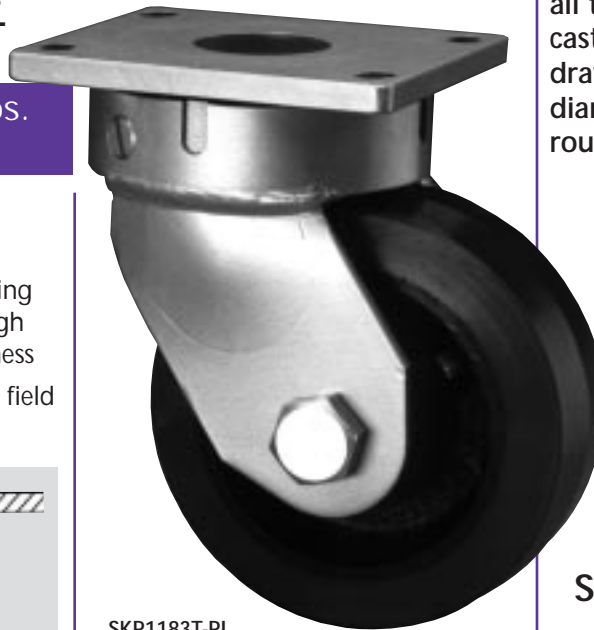

SKP1183T-PI

Optional Features

- **Bolt on Swivel Lock** (Suffix-SL)
- **Wheel Brake options**
Face Contact Brake (suffix-FCB)
Thumb Screw Brake (suffix-WB)

APPLICATIONS:

Used on mobile equipment of all types. Heavier capacity casters are suitable for power drawn applications. Large diameter wheels available for rougher surfaces.



Standard Top Plate

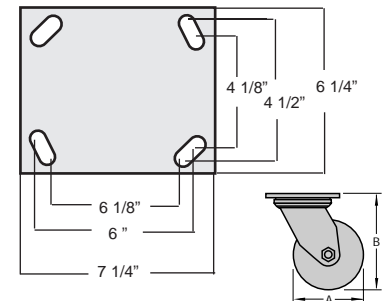

Wheel Specifications					Caster Specifications					Part Number			
Dia. "A" Inches (mm)	Tread Inches (mm)	Wheel Composition	Ref. to Page	Bearing Type	Axle Dia. Inches (mm)	Load Capacity lbs. (KGS)	Overall Height "B" Inches (mm)	Swivel Radius Inches (mm)	Attach. Bolt Inches (mm)	Approx. Shipping Wt.		Swivel Caster	Rigid Caster
										Swivel lbs. (KGS)	Rigid lbs. (KGS)		
6 (152)	2 1/2 (60)	Forged Steel	88	Roller	1 (25)	4000 (1800)	8 1/2 (216)	5 1/2 (140)	1/2 (13)	35 (16)	27 (12)	SKP11625R-FS	RKP11625R-FS
		Cast Iron	86	Roller		2500 (900)				31 (14)	23 (10)	SKP1163R-SS	RKP1163R-SS
	Phenolic	82	Roller	2000 (900)		25 (11)				17 (8)	SKP1163R-PH	RKP1163R-PH	
	Polyurethane (Cast Iron Core)	78	Tapered Roller	2000 (900)		33 (15)				25 (11)	SKP1163T-PI	RKP1163T-PI	
	Forged Steel	88	Tapered Roller	10000 (4500)		36 (17)				28 (13)	SKP1163T-FS	RKP1163T-FS	
8 (203)	2 1/2 (60)	Forged Steel	88	Roller	1 (25)	4000 (1800)	10 1/2 (267)	6 1/2 (165)	1/2 (13)	37 (17)	29 (14)	SKP11825R-FS	RKP11825R-FS
		Cast Iron	86	Roller		2500 (1140)				34 (15)	26 (12)	SKP1183R-SS	RKP1183R-SS
		Phenolic	82	Roller		2500 (1140)				29 (13)	20 (9)	SKP1183R-PH	RKP1183R-PH
		Polyurethane (Cast Iron Core)	78	Tapered Roller		2500 (1140)				36 (16)	27 (12)	SKP1183T-PI	RKP1183T-PI
		Forged Steel	88	Tapered Roller		5500 (2500)				39 (17)	31 (14)	SKP1183T-FS	RKP1183T-FS
	4 (102)	Cast Iron	86	Roller		4000 (1800)				46 (21)	39 (18)	SKP1184R-SS	RKP1184R-SS
		Polyurethane (Cast Iron Core)	78	Tapered Roller		3500 (1590)				45 (20)	38 (17)	SKP1184T-PI	RKP1184T-PI
		Cast Iron	86	Roller		2500 (1140)				45 (20)	37 (16)	SKP11103R-SS	RKP11103R-SS
		Phenolic	82	Roller		2600 (1200)				32 (15)	24 (11)	SKP11103R-PH	RKP11103R-PH
10 (254)	3 (76)	Polyurethane (Cast Iron Core)	78	Tapered Roller	3000 (1360)	48 (22)	40 (18)	SKP11103T-PI	RKP11103T-PI				
		Forged Steel	88	Tapered Roller	6000 (2720)	52 (24)	44 (20)	SKP11103T-FS	RKP11103T-FS				
		Polyurethane (Cast Iron Core)	78	Tapered Roller	4200 (1900)	60 (27)	52 (24)	SKP11104T-PI	RKP11104T-PI				
		Forged Steel	88	Tapered Roller	10000 (4500)	66 (30)	58 (26)	SKP11104T-FS	RKP11104T-FS				
	4 (102)	Phenolic	82	Roller	4000 (1800)	51 (23)	39 (18)	SKP11235R-PH	RKP11235R-PH				
12 (305)	4 (102)	Polyurethane (Cast Iron Core)	78	Tapered Roller	4800 (2200)	70 (32)	59 (27)	SKP1124T-PI	RKP1124T-PI				

SERIES KP12 KINGPIN-FREE HEAVY DUTY

Capacities to 20,000 lbs.



APPLICATIONS:

Equipment requiring high capacity coupled with construction suitable for powered movement. Large diameter wheel selections allow for movement over rough surfaces such as pavement or cement lots.



Standard Features

- **Top Plate/Yoke Base** - AISI 1045 Steel one piece forging precision machined and through hardened. 1/2" top plate thickness
- **Yoke Base** - is pre-notched for field installable swivel lock.



- **Swivel Section** - 3/4" ball bearings mounted in a 7" diameter precision raceway.
- **Legs** - 1/2" formed steel to increase strength and welded to yoke base using 100,000 PSI weld filler, welded inside and out.
- **Axel** - 1 1/4" diameter.

Optional Features

- **Bolt on Swivel Lock (Suffix-SL)**
- **Wheel Brake options**
face contact brake (suffix-FCB)
thumb screw brake (suffix-WB)

Standard Top Plate

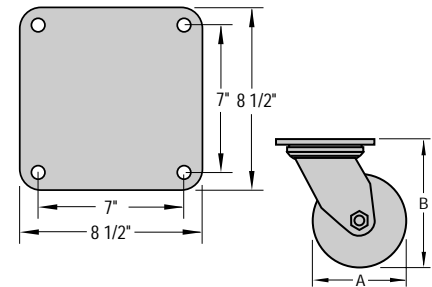

Wheel Specifications						Caster Specifications						Part Number	
Dia. "A" Inches (mm)	Tread Inches (mm)	Wheel Composition	Ref. to Page	Bearing Type	Axle Dia. Inches (mm)	Load Capacity lbs. (KGS)	Overall Height "B" Inches (mm)	Swivel Radius Inches (mm)	Attach. Bolt Inches (mm)	Approx. Shipping Wt.		Swivel Caster	Rigid Caster
										Swivel lbs. (KGS)	Rigid lbs. (KGS)		
8 (203)	4 (102)	Cast Iron	86	Tapered Roller	1 1/4 (32)	6000 (2700)	11 (279)	6 1/4 (159)	5/8 (16)	69 (31)	48 (22)	SKP1284T-SS	RKP1284T-SS
		Forged Steel	88	Tapered Roller		10000 (4500)				73 (33)	52 (24)	SKP1284T-FS	RKP1284T-FS
		Polyurethane (Cast Iron Core)	78	Tapered Roller		3500 (1600)				70 (32)	49 (22)	SKP1284T-PI	RKP1284T-PI
10 (254)	4 (102)	Cast Iron	88	Tapered Roller	1 1/4 (32)	4000 (1800)	13 (330)	7 1/2 (191)	5/8 (16)	76 (35)	59 (29)	SKP12104T-SS	RKP12104T-SS
		Forged Steel	86	Tapered Roller		20000 (9000)				84 (38)	67 (30)	SKP12104T-FS	RKP12104T-FS
		Mold-on Rubber (Cast Iron Core)	74	Tapered Roller		1400 (636)				80 (36)	63 (29)	SKP12104T-MR	RKP12104T-MR
		Polyurethane (Cast Iron Core)	78	Tapered Roller		4200 (1909)				81 (37)	64 (30)	SKP12104T-PI	RKP12104T-PI
	5 (127)	Polyurethane (Cast Iron Core)	78	Tapered Roller	1 1/4 (32)	5000 (2250)	13 (330)	8 (203)	5/8 (16)	88 (40)	71 (32)	SKP12105T-PI	RKP12105T-PI
12 (305)	4 (102)	Mold-on Rubber (Cast Iron Core)	74	Tapered Roller	1 1/4 (32)	1600 (727)	15 1/2 (394)	9 1/4 (235)	5/8 (16)	78 (35)	61 (28)	SKP12124T-MR	RKP12124T-MR
		Polyurethane (Cast Iron Core)	78	Tapered Roller		4800 (2182)				77 (35)	60 (27)	SKP12124T-PI	RKP12124T-PI
	5 (127)	Polyurethane (Cast Iron Core)	78	Tapered Roller	1 1/4 (32)	6000 (2700)				90 (41)	73 (33)	SKP12125T-PI	RKP12125T-PI
	6 (152)	Polyurethane (Cast Iron Core)	78	Tapered Roller	1 1/4 (32)	7500 (3409)				93 (42)	76 (34)	SKP12126T-PI	RKP12126T-PI
16 (406)	4 (102)	Mold-on Rubber (Cast Iron Core)	74	Tapered Roller	1 1/4 (32)	1900 (864)	19 (483)	12 1/2 (318)	5/8 (16)	96 (44)	79 (36)	SKP12164T-MR	RKP12164T-MR
		Polyurethane (Cast Iron Core)	78	Tapered Roller		5970 (2713)				95 (44)	78 (36)	SKP12164T-PI	RKP12164T-PI
	5 (127)	Mold-on Rubber (Cast Iron Core)	74	Tapered Roller	1 1/4 (32)	2570 (1168)				102 (46)	85 (37)	SKP12165T-MR	RKP12165T-MR
	Polyurethane (Cast Iron Core)	78	Tapered Roller	7700 (4000)	101 (46)	84 (39)				SKP12165T-PI	RKP12165T-PI		

SERIES KP13 KINGPIN-FREE DUAL WHEEL

Capacities to 30,000 lbs.

Standard Features

- **Top Plate** - AISI 1045 steel one piece forging precision machined and through hardened, $\frac{3}{4}$ " top plate thickness.
- **Yoke Base** - AISI 1045 steel forging, welded using 100,000 PSI weld filler to $\frac{3}{4}$ " thick adapter plate. Pre-notched for field installable swivel lock.
- **Swivel Assembly** - $\frac{7}{8}$ " ball bearings mounted in a 7" diameter precision raceway.
- **Legs** - $\frac{3}{4}$ " steel welded to Yoke Base, inside and out.
- **Axle** - $1\frac{1}{4}$ " diameter.

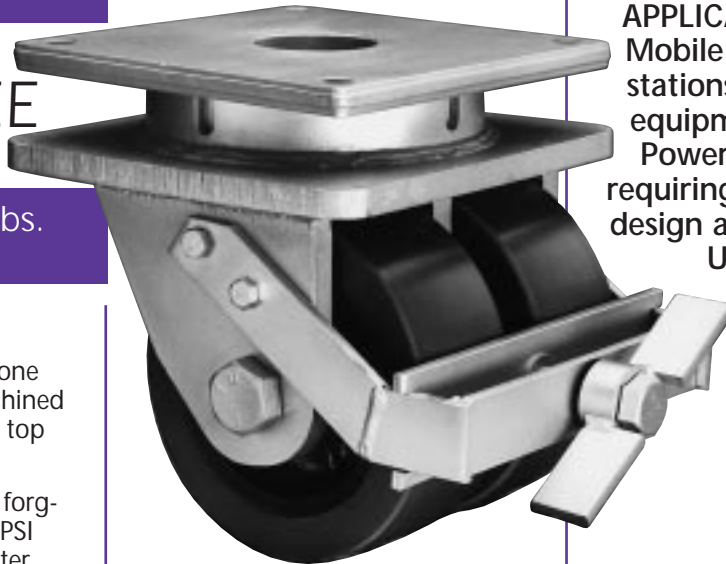
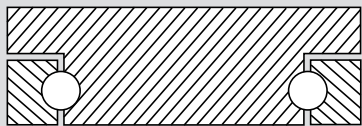

KP13124T-PI-FCB

Optional Features

- **Face Contact Brake** (Suffix -FCB)
- **4-Position Swivel Lock** (Suffix -SL)
- **Special Designs** (Consult Factory)
 - Single wheel
 - Spring loaded shock absorbing

APPLICATIONS:
Mobile platforms, work stations, ground support equipment of all types. Power drawn applications requiring superior capacity, design and construction. Unique swivel assembly suitable for loads up to 30,000 pounds ensures load safety.

Standard Top Plate

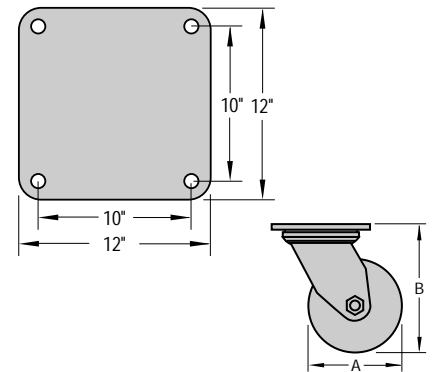

Wheel Specifications						Caster Specifications					Part Number		
Dia. "A" Inches (mm)	Tread Inches (mm)	Wheel Composition	Ref. to Page	Bearing Type	Axle Dia. Inches (mm)	Load Capacity lbs. (KGS)	Overall Height "B" Inches (mm)	Swivel Radius Inches (mm)	Attach. Bolt Inches (mm)	Approx. Shipping Wt.		Swivel Caster	Rigid Caster
										Swivel lbs. (KGS)	Rigid lbs. (KGS)		
10 (254)	4 (102)	Forged Steel	88	Tapered Roller	1 1/4 (32)	30000 (22)	14 3/4 (375)	8 1/4 (210)	3/4 (19)	112 (51)	92 (42)	SKP13104T-FS	RKP13104T-FS
		Mold-on Rubber (Cast Iron Core)	74	Tapered Roller		2800 (1272)				110 (50)	90 (41)	SKP13104T-MR	RKP13104T-MR
		Polyurethane (Cast Iron Core)	78	Tapered Roller		8400 (3818)				111 (50)	91 (41)	SKP13104T-PI	RKP13104T-PI
		Severe Duty Polyurethane	79	Tapered Roller		8400 (3818)				116 (53)	96 (44)	SKP13104T-PS	RKP13104T-PS
12 (305)	4 (102)	Mold-on Rubber (Cast Iron Core)	74	Tapered Roller	1 1/4 (32)	3200 (1454)	15 3/4 (400)	9 1/4 (235)	3/4 (19)	118 (54)	98 (45)	SKP13124T-MR	RKP13124T-MR
		Polyurethane (Cast Iron Core)	78	Tapered Roller		9600 (4363)				120 (55)	100 (45)	SKP13124T-PI	RKP13124T-PI
		Severe Duty Polyurethane	79	Tapered Roller		9600 (4363)				125 (57)	105 (48)	SKP13124T-PS	RKP13124T-PS
	4 1/2 (127)	Press-on Polyurethane	N/A	Tapered Roller		6600 (3000)				130 (59)	110 (50)	SKP131245T-PO	RKP131245T-PO
	5 (127)	Polyurethane (Cast Iron Core)	78	Tapered Roller		12000 (6000)				134 (61)	114 (52)	SKP13125T-PI	RKP13125T-PI
	6 (152)	Polyurethane (Cast Iron Core)	78	Tapered Roller		15000 (6818)				146 (66)	126 (57)	SKP13126T-PI	RKP13126T-PI
16 (305)	4 (102)	Mold-on Rubber (Cast Iron Core)	74	Tapered Roller	1 1/4 (32)	3980 (1809)	19 3/4 (501)	12 1/2 (318)	3/4 (19)	140 (64)	120 (55)	SKP13164T-MR	RKP13126TMR
		Polyurethane (Cast Iron Core)	78	Tapered Roller		11940 (5427)				148 (67)	128 (58)	SKP13164T-PI	RKP13164T-PI
	5 (127)	Mold-on Rubber (Cast Iron Core)	74	Tapered Roller		5140 (2336)				150 (68)	130 (59)	SKP13165T-MR	RKP13165T-MR
	Polyurethane (Cast Iron Core)	78	Tapered Roller	15400 (7000)		156 (71)				136 (62)	SKP13165T-PI	RKP13165T-PI	
18 (457)	5 (127)	Mold-on Rubber (Cast Iron Core)	74	Tapered Roller	1 1/4 (32)	5600 (2545)	22 (559)	14 1/4 (362)	3/4 (19)	180 (82)	160 (73)	SKP13185T-MR	RKP13185T-MR
		Polyurethane (Cast Iron Core)	78	Tapered Roller		16800 (7636)				185 (84)	165 (75)	SKP13185T-PI	RKP13185T-PI
	9 (229)	Press-on Polyurethane	N/A	Tapered Roller		20000 (9090)		210 (95)		190 (86)	SKP13189T-PO	RKP13189T-PO	