

# DESIGNER CASTERS

Capacities to 175 lbs.

High Style casters for use on seating, business machines, or institutional equipment. Meets or exceeds BIFMA durability standards. Hundreds of combinations of bodies, attachments, finishes and options.

FOR A COMPLETE LISTING OF AVAILABLE PRODUCTS REFER TO PAGES 64-66

## METAL BALL CASTERS WITH DIE CAST BODIES



**MB**

Hard wheel for carpet  
1 1/2", 2", 2 1/2" wheels



**MB-SR**

Soft wheel for  
hard floors  
1 9/16", 2 1/4", 3" wheels



**MBS-SR**

Slimline design  
Soft wheel for hard  
floors  
2 1/2", 3", wheels



**-B**

Optional wheel brake

## TWIN WHEEL CASTERS



**TWD**

Die cast body  
Hard wheel for Carpet  
50mm (2") & 60mm  
(2 3/8") wheels



**TWD-U**

Die cast body  
Urethane soft tread for  
hard floors  
50mm (2") & 60mm  
(2 3/8") wheels



**-B**

Optional wheel brake



Special order unhooded  
design



**TWN & TWN-U**

Nylon body  
Hard or urethane tread  
30mm to 60mm



**TWH & TWH-U**



Heavy duty nylon body  
Hard or urethane tread  
75mm, 100mm, 125mm



High style  
special application casters.  
Custom engineering available.

# DESIGNER CASTERS

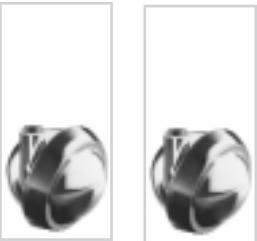
- *Metal ball casters with hard or soft treads*
- *Twin wheel casters with die cast metal or nylon, fully hooded body and hard or soft tread*
- *Big twin wheel casters to 125mm (5"). Unhooded nylon body. Soft or hard wheels.*

							
Caster Body Type Wheel Material	Metal Ball Hard Tread		Metal Ball Rubber Tread		Slimline Metal Ball	Die Cast -Twin Wheel Nylon or Urethane*	
Wheel Diameter	2"	2 1/2"	2 1/4"	3"	3"	50 mm	60 mm
Load Capacity (lbs)	75	100	75	90	100	75	100
Mounting Height	2 1/8"	3"	2 5/8"	3 1/4"	3 1/4"	2 1/4"	2 3/4"
Style	MB	MB	MB-SR	MB-SR	MBS-SR	TWD TWD-U*	TWD TWD-U*
ATTACHMENTS							
Square Plate							
#9L	MB-2-9L-	MB-25-9L-	MB-SR-22-9L-	MB-SR-30-9L-	MBS-SR-30-9L-	TWD-N*-50-9L-	TWD-N*-60-9L-
#92L	-	-	-	-	-	-	-
Rectangular Plate #91L	MB-2-91L-	MB-25-91L-	MB-SR-22-91L-	MB-SR-30-91L-	MBS-SR-30-91L-	TWD-N*-50-91L-	TWD-N*-60-91L-
Grip Neck Stem #8L	MB-2-8L-	MB-25-8L-	MB-SR-22-8L-	MB-SR-30-8L-	MBS-SR-30-8L-	TWD-N*-50-8L-	TWD-N*-60-8L-
Straight Stem #SL	-	MB-25-SL-	-	MB-SR-30-SL-	MBS-SR-30-SL-	-	TWD-N*-60-SL-
Friction Ring Stems							
#HL (3/8 x 1)	MB-2-HL-	MB-25-HL-	MB-SR-22-HL-	MB-SR-30-HL-	MBS-SR-30-HL-	TWD-N*-50-HL-	TWD-N*-60-HL-
#G1 (7/16 x 1 3/8)	MB-2-G1-	MB-25-G1-	MB-SR-22-G1-	MB-SR-30-G1-	MBS-SR-30-G1-	TWD-N*-50-G1-	TWD-N*-60-G1-
#G2 (7/16 x 1)	MB-2-G2-	MB-25-G2-	MB-SR-22-G2-	MB-SR-30-G2-	MBS-SR-30-G2-	TWD-N*-50-G2-	TWD-N*-60-G2-
Threaded Stems							
• 5/16 - 18 x 1"	-	MB-25-51-	MB-SR-22-51-	-	-	TWD-N*-50-51-	--
• 3/8 - 16 x 3/4"	MB-2-37-	MB-25-37-	MB-SR-22-37-	MB-SR-30-37-	MBS-SR-30-37-	TWD-N*-50-37-	TWD-N*-60-51
• 3/8 - 16 x 1"	-	-	-	-	-	-	-
• 3/8 - 16 x 1 1/2"	MB-2-32-	MB-25-32-	MB-SR-22-32-	MB-SR-30-32-	MBS-SR-30-32-	TWD-N*-50-32-	TWD-N*-60-G2-32
• 1/2 - 13 x 1 1/2"	-	-	-	-	-	-	-
FINISH CHOICES							
	A, BB, BC, SC	A, BB, BC, SC	A, BB, BC, SC	A, BB, BC, SC	BC, SC	A, BL, BB, BC, SC	A, BL, BB, BC, SC
OPTIONS							
	T	T, B	None	B, C	B,C	B, U*	U*

# DESIGNER CASTERS

## IN-STOCK SELECTIONS

PART NUMBER SYSTEM					
Caster Body	Wheel Type	Wheel Size	Attachment	Finish	Options
MB	- SR	- 30	- 9L	- SC	- B



### Nylon Body - Twin Wheel Nylon or Urethane\*

50 mm	60 mm	75 mm	100 mm	125 mm
90	100	130	130	150
2 1/4"	2 3/4"	3 5/32"	4 19/32"	5 23/32"
TWN TWN-U*	TWN TWN-U*	TWH TWH-U*	TWH TWH-U*	TWH TWH-U*

### ATTACHMENTS

TWN-N*-50-9L-	TWN-N*-60-9L-	-	-	-
-	-	TWH-N*-75-92L-	TWH-N*-100-92L-	TWH-N*-125-92L-
-	TWN-N*-60-91L-	TWH-N*-75-91L-	TWH-N*-100-91L-	TWH-N*-125-91L-
TWN-N*-50-8L-	-	-	-	-
-	TWN-N*-60-SL-	-	-	-
-	TWN-N*-60-HL-	TWH-N*-75-HL-	-	-
TWN-N*-50-G1-	TWN-N*-60-G1-	TWH-N*-75-G1-	TWH-N*-100-G1-	TWH-N*-125-G1-
TWN-N*-50-G2-	TWN-N*-60-G2-	-	-	-
TWN-N*-50-51-	TWN-N*-60-51-	-	-	-
TWN-N*-50-37-	TWN-N*-60-37-	-	-	-
-	-	TWH-N*-75-31-	-	-
TWN-N*-50-32-	TWN-N*-60-32-	-	-	-
-	-	TWH-N*-75-12-	TWH-N*-100-12-	TWH-N*-125-12-

### FINISH CHOICES

A, BL, BB, BC, SC	A, BB, BC, BL	BL	BL	BL
----------------------	------------------	----	----	----

### OPTIONS

B, U*	B, U*	B, U*	B, U*	B, U*
-------	-------	-------	-------	-------

### Caster Body

- Metal Ball
- Metal Ball/Rubber Tread
- Metal Ball - Slimline style
- Twin Wheel

### Wheel Material

- Hard Tread - metal (M) or nylon (N) use on soft surface like carpeting
- Soft rubber (SR) or urethane (U) treads protect hard floors like tile or hardwood

### Wheel Size

- Larger wheels roll easier

### Attachments

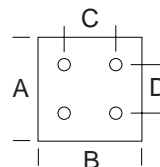

### PLATE

#	Shape	A x B	C x D	Bolt Size
9L	SQ	1 1/2 x 1 1/2	1 x 1	3/16"
92L	RECT	2 5/32 x 2 9/16	1 5/8 x 2	5/16"
91L	RECT	1 3/16 x 2	1 3/16 x 1 9/16	3/16"

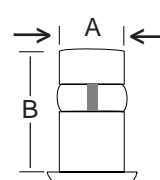

### FRICTION RING

#	A	B
HL	3/8"	1"
G1	7/16"	1 3/8"
G2	7/16"	1"

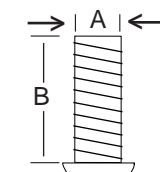

### THREADED STEM

#	A (dia & threads/in)	B
51	5/16" - 18	1"
37	3/8" - 16	3/4"
31	3/8" - 16	1"
32	3/8" - 16	1 1/2"
12	1/2" - 13	1 1/2"

### Finish

- A = Antique
- BB = Bright Brass
- BC = Bright Chrome
- BL = Black
- SC = Satin Chrome

### Options

- B = Wheel Brake
- U = Urethane-soft, non-marking tread
- T = Tread protector
- C = Conductive - for anti-static protection

# DESIGNER CASTERS

Hundreds of Choices

Hundreds of designer casters combination choices are available to provide the best application solutions. Available options appear on the following charts. In stock selections are highlighted.

	MB - Metal Ball	MB-SR - Metal Ball - Soft Rubber	MBS-SR - Metal Ball Shimline - Soft Rubber	TWD - Twin Wheel - Die Cast Body	TWD-U - Twin Wheel - Die Cast Body - Urethane Tread	TWN - Twin Wheel - Nylon Body	TWN-U - Twin Wheel - Nylon Body - Urethane Tread	TWH - Twin Wheel Heavy Duty Nylon Body	TWH-U - Twin Wheel Heavy Duty Nylon Body - Urethane Tread
<b>BODY STYLE OPTIONS &amp; LOAD CAPACITIES (lbs)</b>									
<b>SIZES: IN STOCK SELECTIONS HIGHLIGHTED</b>									
1 3/16" (30 mm)						40			
1 9/16" (40 mm)						75			
1 3/4" (45 mm)						75			
2" (50 mm)	75			75	75	75			
2 3/16" (55 mm)						110	110		
2 3/8" (60 mm)				100	100	100	100		
2 1/2"	100		100						
3" (75 mm)		90	100	165	165			130	
3 1/2"									
4" (100 mm)				250	250			130	130
4 1/2"								150	
5" (125 mm)								150	150
<b>ATTACHMENTS</b>									
<b>CODE (See page 67 for sizes) IN STOCK SELECTIONS HIGHLIGHTED</b>									
9L Square Plate	X	X	X	X	X	X	X	X	X
9L Rectangular Plate	X	X	X	X	X	X	X		
9L Square Plate								X	X
Special Rect. Plate (1 3/4" x 3")	X	X	X	X	X				
SL Straight Stem *	X	X	X	X	X				
Special Straight Stem (7/16" x 1 7/8")			X						
HL Friction Ring (3/8" x 1")	X	X	X	X	X	X	X		
G1 Friction Ring (7/16" x 1 3/8")	X	X	X	X	X	X	X	X	X
G2 Friction Ring (7/16" x 1")	X	X	X	X	X	X	X		
Special Friction Ring (7/16" x 1 7/8")								X	X
Special Threaded Stem (5/16 - 18 x 1/2")*	X			X	X				
Special Threaded Stem (1/4 - 20 x 5/8")*	X	X	X	X	X	X	X		
51 Threaded Stem (5/16 - 18 x 1")*	X	X	X	X	X	X	X		
Special Threaded Stem (5/16 - 18 x 7/8")*	X	X	X	X	X				
Special Threaded Stem (5/16 - 18 x 1 1/4")*	X	X	X	X					
Special Threaded Stem (5/16 - 18 x 2")*	X	X	X						
37 Threaded Stem (3/8 - 16 x 3/4")	X	X	X	X	X	X	X		
31 Threaded Stem (3/8 - 16 x 1")								X	
32 Threaded Stem (3/8 - 16 x 1 1/2")	X	X	X	X	X	X	X		
39 Threaded Stem (3/8 - 24 x 5/8")	X	X	X	X	X	X	X		
41 Special Threaded Stem (1/2 - 13 x 1")*			X					X	X
12 Threaded Stem (1/2 - 13 x 1 1/2")								X	X
*This attachment available on some body styles only. Minimum orders may apply.									
<b>FINISH CHOICES</b>									
<b>IN STOCK SELECTIONS HIGHLIGHTED</b>									
A = Antique	X	X		X	X	X	X		
BB = Bright Brass	X	X		X	X	X	X		
BC = Bright Chrome	X	X	X	X	X	X	X		
BL = Black				X	X	X	X	X	X
SC = Satin Chrome	X	X	X	X	X	X	X		
<b>OPTIONS</b>									
<b>IN STOCK SELECTIONS HIGHLIGHTED</b>									
B = Wheel Brake	X	X	X	X	X	X	X	X	X
C = Conductive Rubber *		X	X	X					
ESD = Electrostatic Discharge *				X	X				
F = Fixed (Non-Swivel)	X	X	X	X	X				
L = Left-Hand Model			X						
R = Right Hand Model			X						
T = Tread Protector	X			X		X			
UH = Un-Hooded Body						X	X	X	X
TL = Total Lock (Wheel & Swivel)								X	X
* CASTER-PRO CONDUCTIVE AND ESD TREADS ARE NOT U.L. APPROVED AND CONDUCTIVITY CANNOT BE GUARANTEED. DETAILS AVAILABLE.									

# THE STANDARD SERIES

Capacities to 90 lbs.



SSL-SRP-N-2

The Standard castor features double ball bearing construction. It combines easy swiveling, smooth rolling, long life and economy.

Dia. Inches	Wheel Type	Load Capacity lbs.	Overall Height Inches	Finish	Caster Number
1 5/8	Soft Rubber	70	2 1/4	Copper Ox	S8L-SRP-0-15
2	Soft Rubber	80	2 5/8	Copper Ox	S8L-SRP-0-2
2	Hard Rubber	80	2 5/8	Copper Ox	S8L-HRP-0-2
2 1/2	Hard Rubber	90	3 1/32	Copper Ox	S8L-HRP-0-25
2	Soft Rubber	80	2 17/32	Bright Nickel	SHL-SRP-N-2
2 1/2	Soft Rubber	80	3 1/32	Bright Nickel	SHL-SRP-N-25
2 1/2	Hard Rubber	90	3 1/32	Bright Chrome	SHL-HRP-C-25
2	Soft Rubber	80	2 17/32	Bright nickel	SSL-SRP-N-2
2 1/2	Hard Rubber	90	3 1/32	Bright Chrome	SSL-HRP-C-25
2	Soft Rubber	80	2 17/32	Bright Nickel	SG1-SRP-N-2
2	Soft Rubber	80	2 17/32	Zinc	SG1-SRP-Z-2
2 1/2	Soft Rubber	80	3 1/32	Bright Nickel	SG1-SRP-N-25
2 1/2	Hard Rubber	90	3 1/32	Bright Chrome	SG1-HRP-C-25
1 5/8	Soft Rubber	70	2 5/32	Zinc	ST1-SRP-Z-15
2	Soft Rubber	80	2 17/32	Zinc	ST1-SRP-Z-2
1 5/8	Soft Rubber	70	2 9/32	Zinc	S91L-SRP-Z-15
2	Soft Rubber	80	2 5/8	Zinc	S91L-SRP-Z-2
2	Soft Rubber	90	3 19/32	Copper Ox	S91L-SRP-C-2

Caster numbers call out available stem or plate in second and third character (IE-S91L-SRP-Z-2)

## STEM AND TOP PLATE REFERENCE CHART

Shown at Actual Size

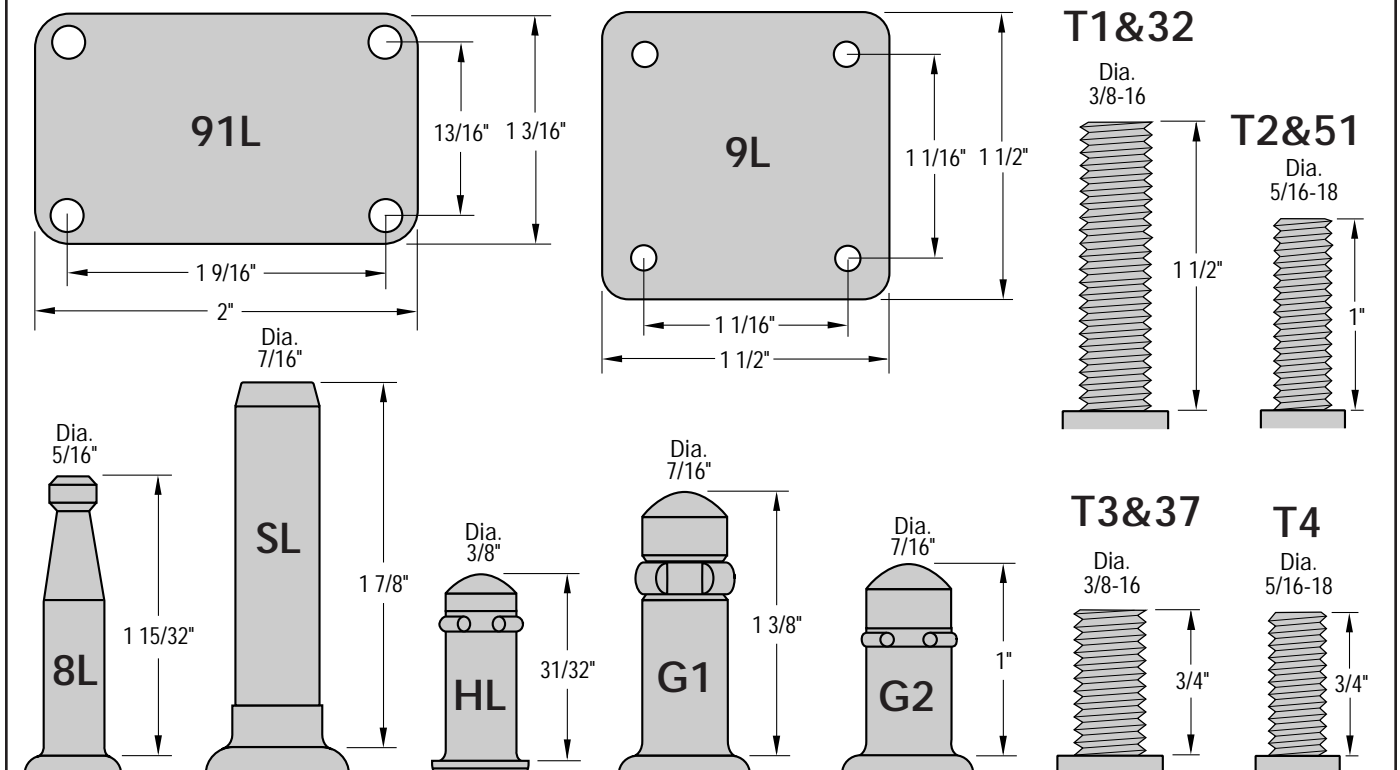

# SOCKETS FOR STEM CASTERS

**Economical Plastic Sockets Cushion Caster Stem # 8L**, Deaden noise by absorbing side thrust. Full contact with bore or tubing wall provides a snug fit. Many sizes and shapes adapt Stem casters to a wide range of wood or metal furniture. For use with a wide variety of caster series where a  $\frac{7}{16}$ " grip ring stem is available in any length up to  $1\frac{7}{8}$ ".

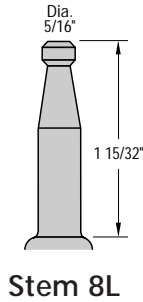

Tubing Outside Diameter Inches	Nom. Hold Diameter Inches	Min. Hole Depth lbs.	Bottom Flange Inches	Socket Number
For Wood Base Chair	.437	1 $\frac{3}{4}$	$\frac{15}{16}$	SOP-671
$\frac{3}{4}$	.680	1 $\frac{7}{16}$	$\frac{7}{8}$	SOP-672
$\frac{7}{8}$	.805	1 $\frac{7}{16}$	$\frac{29}{32}$	SOP-673

Socket SOP-671 Used with Stem 8L

## Reinforced Thermoplastic Sockets

Unlike plastic or steel, sockets will not loosen or wear. This strong material has the same pull out force after the life cycle test as did when first installed.

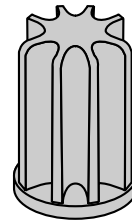

Sockets for Round Tubing

Socket #	Fits Round I.D. Tube
RD1	.777
RD2	.872
RD3	.894
RD4	1.072
RD5	1.12
RD6	1.31
RD7	1.495

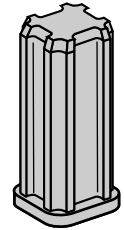

Sockets for Square Tubing

Socket #	Fits Square I.D. Tube
SQ1	.620
SQ2	.650
SQ3	.870
SQ4	.902
SQ5	1.010
SQ6	1.120
SQ7	1.140
SQ8	1.150
SQ9	1.152
SQ10	1.40

# BRACKETS FOR STEM CASTERS

For use with a wide variety of caster series where a  $\frac{7}{16}$ " grip ring stem is available in any length up to  $1\frac{3}{8}$ ".

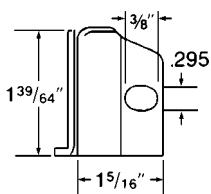

Bolted For Inside Angle Iron Part #BRK-701

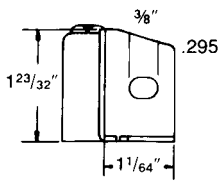

Bolted For Outside Angle Iron Part #BRK-702

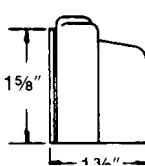

Welded For Inside Angle Iron Part #BRK-703

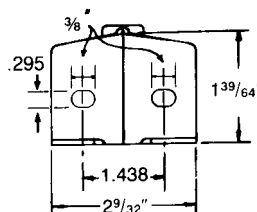

Flat Bracket Part #BRK-704

# PIPE-THREAD SOCKETS



Tube Dia. Inches	Base Size Inches	Socket Number
$\frac{1}{2}$	1	SPT-681
$\frac{3}{4}$	1	SPT-682
$1\frac{1}{16}$	$1\frac{7}{16}$	SPT-683

# KWIK-KLIP®

## Caster Adapters

*These innovative, light weight, non-rusting adapters provide easy mounting & removal of casters from cases and equipment.*

*The original snap-in, snap-out caster adapter.*

### FOR 2" SWIVEL & RIGID CASTERS

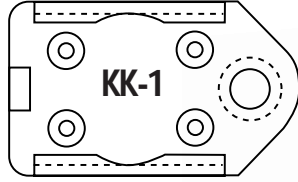

- A380 aluminum
- 3.3 ounces
- Flat mounting

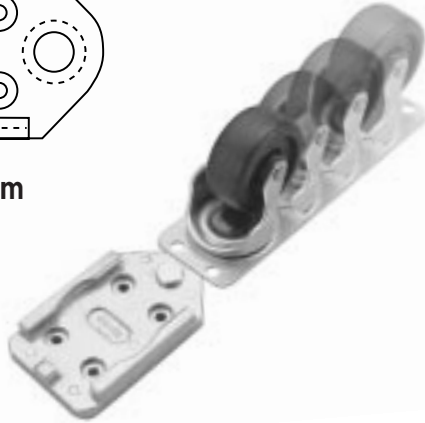

### FOR 2 1/2" TO 5" SWIVEL & RIGID CASTERS

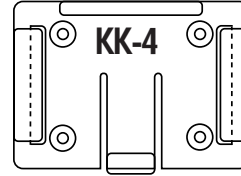

- Reinforced polycarbonate
- Stronger than steel
- 2.9 ounces

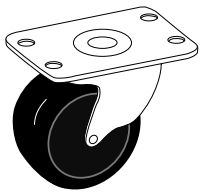

**01**

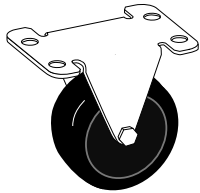

**02**

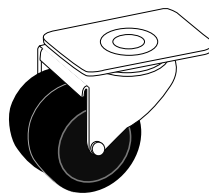

**PC-4KK**

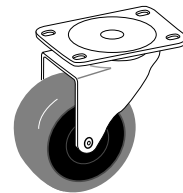

**03**

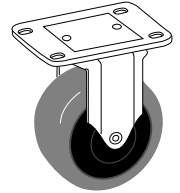

**04**

Swivel Caster Part #	Rigid Caster Part #	Wheel Diameter (inches)	Tread Width (Inches)	Wheel Type	Load Capacity (lbs)	Overall Height (inches)	Swivel Radius (inches)	Mounting Bolt Dia. (inches)	Top Plate DWG.	Use with Kwik-Klip Number
01-SRP-2	02-SRP-2KK	2	1	Soft/Black	90	2 1/2	1 3/4	1/4	SW=A/RIG=B	KK-1
01-HRP-2	02-HRP-2KK	2	1	Hard/Gray	150	2 1/2	1 3/4	1/4	SW=A/RIG=B	KK-1
PC-4KK	Not Avail	2-dual	1 3/4 O.A.	Soft/Black	160	2 27/32	1 3/4	no holes	C	KK-1
03-SRP-3KK	04-SRP-3KK	3	1 1/4	Soft/Black	175	4 1/2	3	5/16	D	KK-4
03-HRP-3KK	04-HRP-3KK	3	1 1/4	Hard/Gray	270	4 1/2	3	5/16	D	KK-4
03-SRP-35	04-SRP-35KK	3 1/2	1 5/16	Soft/Black	200	4 3/4	3 3/16	5/16	D	KK-4
03-HRP-35	04-HRP-35KK	3 1/2	1 5/16	Hard/Gray	275	4 3/4	3 3/16	5/16	D	KK-4
03-SPD-35	04-SPD-35KK	3 1/2	1 5/16	Soft/Gray	180	4 3/4	3 3/16	5/16	D	KK-4
03-SRP-4	04-SRP-4KK	4	1 1/4	Soft/Black	200	5	3 7/16	5/16	D	KK-4
03-HRP-4	04-HRP-4KK	4	1 1/4	Hard/Gray	275	5	3 7/16	5/16	D	KK-4
03-SPD-4	04-SPD-4KK	4	1 1/4	Soft/Gray	200	5	3 7/16	5/16	D	KK-4
03-SRP-5	04-SRP-5KK	5	1 1/4	Soft/Black	200	6 1/8	3 15/16	5/16	D	KK-4
03-HRP-5	04-HRP-5KK	5	1 1/4	Hard/Gray	290	6 1/8	3 15/16	5/16	D	KK-4
03-SPD-5	04-SPD-5KK	5	1 1/4	Soft/Gray	225	6 1/8	3 15/16	5/16	D	KK-4

